

Short Message Service

Global SMS

Product Documentation



Copyright Notice

©2013-2024 Tencent Cloud. All rights reserved.

Copyright in this document is exclusively owned by Tencent Cloud. You must not reproduce, modify, copy or distribute in any way, in whole or in part, the contents of this document without Tencent Cloud's the prior written consent.

Trademark Notice



All trademarks associated with Tencent Cloud and its services are owned by Tencent Cloud Computing (Beijing) Company Limited and its affiliated companies. Trademarks of third parties referred to in this document are owned by their respective proprietors.

Service Statement

This document is intended to provide users with general information about Tencent Cloud's products and services only and does not form part of Tencent Cloud's terms and conditions. Tencent Cloud's products or services are subject to change. Specific products and services and the standards applicable to them are exclusively provided for in Tencent Cloud's applicable terms and conditions.

Contents

Global SMS

Global SMS Intro

Overview

Features

Scenarios

Sender ID

Global SMS Pricing

Billing Overview

Pricing

Getting Started

Global SMS

Global SMS Intro

Overview

Last updated : 2024-01-18 16:21:35

Global SMS Overview

Tencent Cloud Global SMS collaborates with a great number of premium direct connection channels across the world, covers over 1,000 global carriers, and supports multiple languages to enable you to send verification codes, notifications, and marketing SMS conveniently. It is designed to help you reach global users and promote your global business expansion with ease and speed.

Strengths of Global SMS

Global reach and easy access

Global SMS enables you to send messages to users in more than 220 countries and regions through over 1,000 global carriers. And simple and straightforward documentation helps you integrate SMS in as little as ten minutes and launch the service in under one hour via the Tencent Cloud Console, API, or SDK.

Real-time monitoring

Global SMS works with premium direct connection channels across the world. Over 90% of messages can be received within 10 seconds. A delivery status report will be returned immediately after a message is sent. Real-time monitoring and smart scheduling ensure service security and reliability.

Comprehensive statistical analysis

Global SMS provides multi-dimensional statistics on the number of messages sent, delivery success rate, failure causes, and receipt analysis, SMS messages sent to a specific mobile number, and the number of SMS messages sent and success rate based on a specific template over a specific period of time.

Features

Last updated : 2024-03-28 19:19:34

Global SMS provides various services such as SMS verification code, system notification, and event notification, meeting your diverse needs in basic services and marketing campaigns.

Customizable Signatures

An SMS signature placed at the beginning of your message lets recipients quickly see your company name, product name, or business name. You can use the name or abbreviation of your company, trademark, product, or website as the signature. You do not need to carry a signature when sending global SMS messages. A signature is optional.

Message Templates

You can create templates to send verification codes, system notifications, promotional information, and other messages. Templates feature customizable variable parameters that allow you to make messages more personalized for your users.

Message Delivery

After your message template is approved, you can send messages to recipients across the world conveniently via the SMS console, API, or SDK.

Message Status

The SMS console allows you to easily check the status of each message you send, including the success or failure rate and the actual number of message fragments in each message.

Unauthorized Usage Protection

The default daily sending limit of Global SMS for a single Tencent Cloud account is 100 messages. (referring to the actual number of [submitted billing messages](#). For users before July 31, 2023, the default daily sending limit of Global SMS is 1000.). The current daily limit of the account can be viewed in the **Global SMS Daily Sending Limit (Account Level)** module in [Console > Overview Page](#). If you need to make adjustments, please consult your Tencent Cloud business manager or [submit a ticket](#).

Global SMS allows you to set alarms for excessive daily message traffic. If a user sends excessive messages, the system will send an alarm to specified alarm recipients, helping you reduce or avoid losses caused by potential unauthorized usage.

We also provide the ability to set the sending country/region, allowing you to specify that an application can only send messages to designated countries/regions, reducing the risk of theft.

Statistical Reports

You can get comprehensive statistics for messages sent during certain time periods, including message volume, delivery rate based on templates, failure details, and view records of messages delivered to specific mobile numbers.

Scenarios

Last updated : 2024-01-18 16:21:35

SMS Verification Codes

Send SMS verification codes to your users when they sign up, log in, change their password, make a payment, or verify their identity on your app or website. SMS provides reliable support for apps with hundreds of millions of users worldwide, including QQ and WeChat, with more than 3 billion messages sent every month.

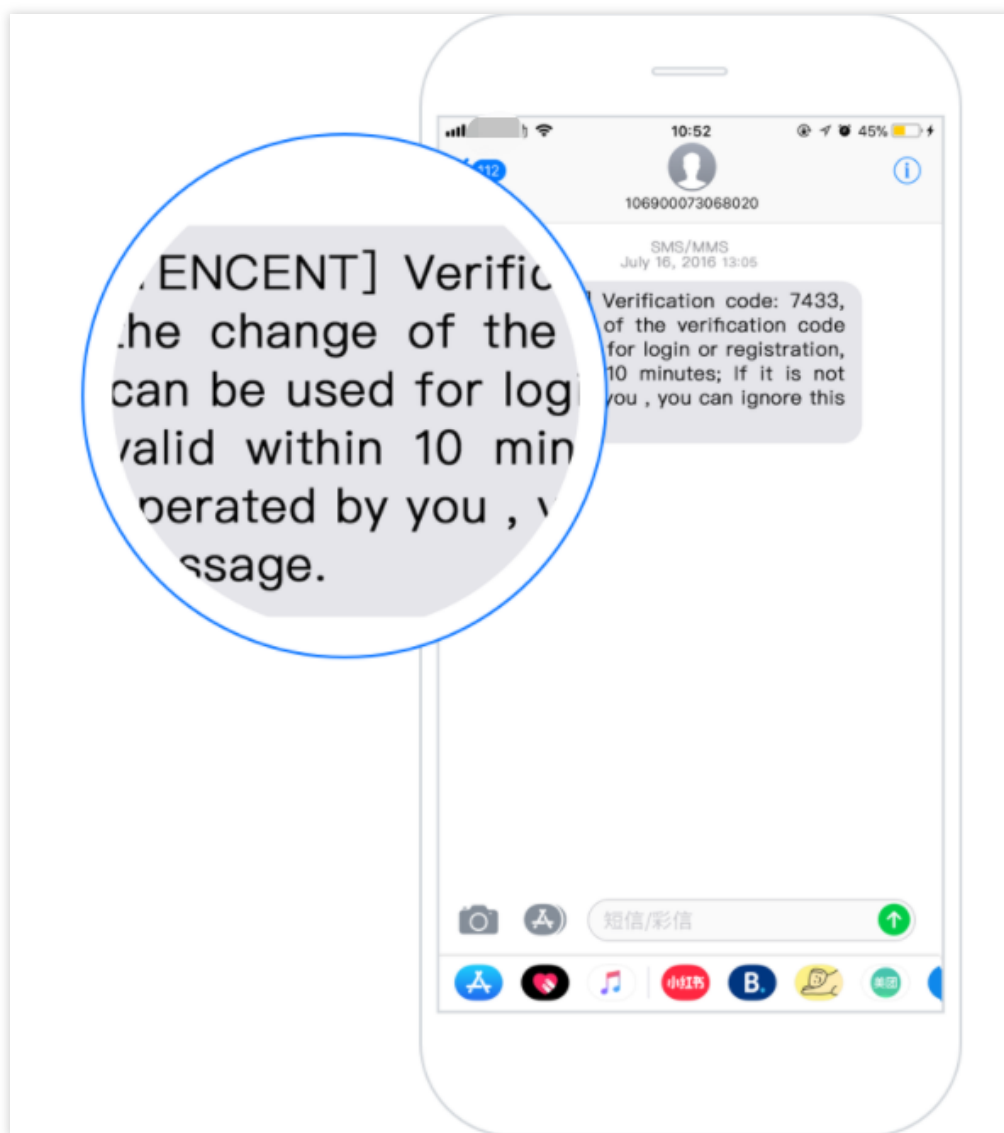

System Notifications

Send notifications to users related to payments, suspicious logins, order confirmations, consumption reminders, shipment tracking, price change, and system updates or maintenance.

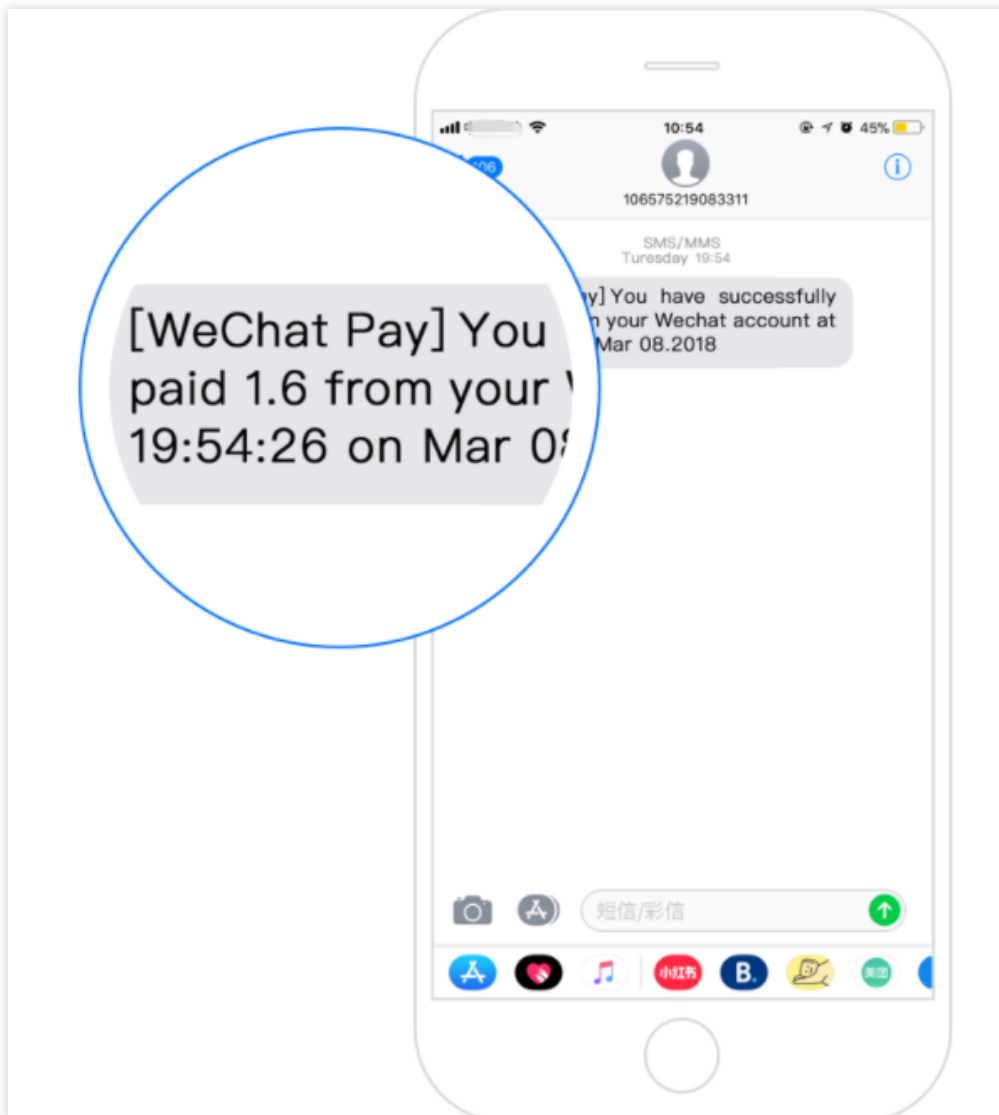

Marketing and Promotional Messages

Send marketing and promotional messages on various topics such as customer care, holiday greetings, new product launches, product deals, discounts, business promotions, and events to broaden your customer reach.

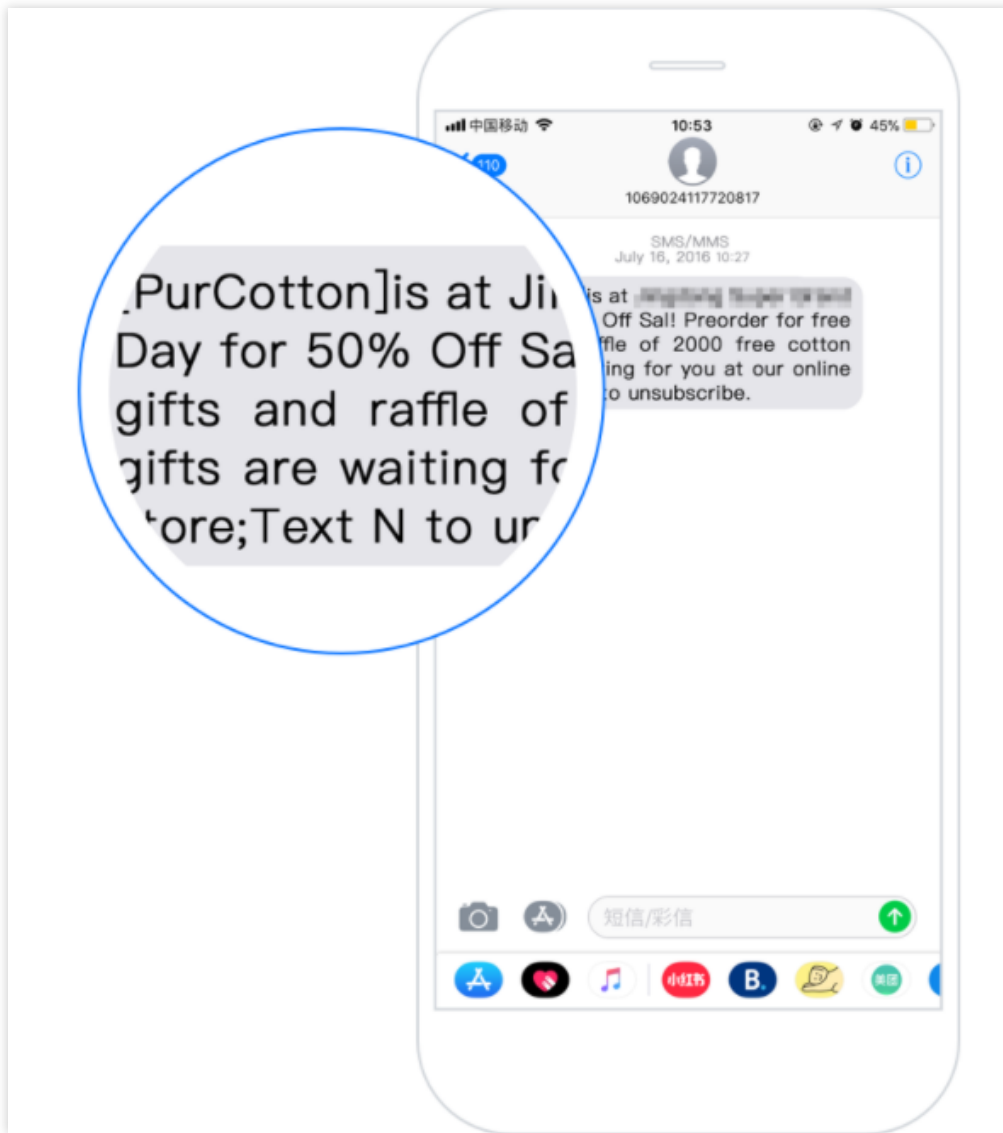

Sender ID

Last updated : 2024-09-04 17:45:58

Sender ID

The Sender ID is the name displayed as the Sender of the SMS message on the recipient's device, which is an effective way to brand yourself to recipients.

Due to the involvement of many countries/regions in the international SMS message, the presentation of Sender ID varies accordingly, and can be roughly categorized into two types:

Alphabetical Sender ID

For countries/regions that support alphabetical (alphanumeric), the Sender ID can be customized and is typically 3-11 English characters. Special characters are not permitted, except for "_" and "-". It is generally required that the Sender ID is associated with the client's company name or brand.

Numeric Sender ID

The numeric Sender ID cannot be customized, and different countries have different application requirements.

Sender ID Reporting Rules

Globally, some countries/regions do not require registration to send messages. Tencent Cloud platform requires customers to provide basic information for review before sending specified Sender ID and content.

Note:

With the promotion of DND and the emphasis on user privacy, it is required to register a Sender ID. In the future, more and more countries and regions will be able to send SMS messages.

| Country/Region | Country/Region Code | Sender ID Guideline | Registration Required | SMS Content Whitelist Required | Fee | Remarks |
|----------------------|---------------------|------------------------|-----------------------|--------------------------------|------|-----------------------------------------------------------------------------|
| Andorra | AD | Alphanumeric Sender ID | No | - | Free | - |
| United Arab Emirates | AE | Alphanumeric Sender ID | Yes | - | Free | 1. Local authentication required. Please refer to the relevant regulations. |

| | | | | | | |
|---------------------|----|------------------------|-----|---|------|----------------------------------------------------------------------------------------------------|
| | | | | | | and sign; 2. A trade 3. M mus e.g. 4. If the c prov own 5. ID pers licen requ |
| Afghanistan | AF | Alphanumeric Sender ID | Yes | - | Free | If the inco com on th prov own purc regis certi |
| Antigua and Barbuda | AG | Alphanumeric Sender ID | No | - | Free | - |
| Anguilla | AI | Alphanumeric Sender ID | No | - | Free | - |
| Albania | AL | Alphanumeric Sender ID | No | - | Free | - |
| Armenia | AM | Alphanumeric Sender ID | Yes | - | Free | - |
| Angola | AO | Alphanumeric Sender ID | No | - | Free | - |
| Argentina | AR | Numeric Sender ID | No | - | Free | - |
| American Samoa | AS | Alphanumeric Sender ID | No | - | Free | - |

| | | | | | | |
|------------------------|----|------------------------|-----|-----|------|-------------------------------------|
| Austria | AT | Alphanumeric Sender ID | No | Yes | Free | - |
| Australia | AU | Alphanumeric Sender ID | Yes | - | Free | LOA is re attac lette Engl |
| Aruba | AW | Alphanumeric Sender ID | No | - | Free | - |
| Azerbaijan | AZ | Alphanumeric Sender ID | No | - | Free | - |
| Bosnia and Herzegovina | BA | Alphanumeric Sender ID | Yes | - | Free | - |
| Barbados | BB | Alphanumeric Sender ID | No | - | Free | - |
| Bangladesh | BD | Alphanumeric Sender ID | No | - | Free | - |
| Belgium | BE | Numeric Sender ID | No | Yes | Free | - |
| Burkina Faso | BF | Alphanumeric Sender ID | No | - | Free | - |
| Bulgaria | BG | Alphanumeric Sender ID | Yes | - | Free | - |
| Bahrain | BH | Alphanumeric Sender ID | Yes | - | Free | -- |
| Burundi | BI | Alphanumeric Sender ID | No | - | Free | - |
| Benin | BJ | Alphanumeric Sender ID | No | - | Free | - |
| Bermuda | BM | Alphanumeric Sender ID | No | - | Free | - |
| Brunei | BN | Alphanumeric Sender ID | No | - | Free | - |
| | | | | | | |

| | | | | | | |
|----------|----|-----------------------------------------------------------------------------------------|-----|----------------------------------------------------|-------------------------|------------------------------------------------------------------------------------------------------------|
| Bolivia | BO | Alphanumeric Sender ID | No | - | Free | - |
| Brazil | BR | Numeric Sender ID | No | - | Free | Send over long |
| Bahamas | BS | Numeric Sender ID | No | - | Free | |
| Bhutan | BT | Alphanumeric Sender ID | No | - | Free | - |
| Botswana | BW | Alphanumeric Sender ID | No | - | Free | - |
| Belarus | BY | Alphanumeric Sender ID | Yes | - | Free | - |
| Belize | BZ | Alphanumeric Sender ID (Sender IDs will be overwritten to short code by some operators) | No | - | Free | - |
| Canada | CA | Toll-Free Number (TFN) | Yes | No, SMS content needs to be whitelisted by Tencent | Log in for more details | 1. You exclude Send general customer type OTF sub OTF Marl separate reco will a Send ensu diffe 3. It a br |

| | | | | | | |
|----------------------------------|----|------------------------|-----|-----|------|------------------------------------------------------|
| | | | | | | cont [Ten is 12 |
| Democratic Republic of the Congo | CD | Alphanumeric Sender ID | No | - | Free | - |
| Central African Republic | CF | Alphanumeric Sender ID | No | - | Free | - |
| Republic of the Congo | CG | Alphanumeric Sender ID | Yes | - | Free | If the inco com on th prov own purc regis certi |
| Switzerland | CH | Alphanumeric Sender ID | No | Yes | Free | - |
| Ivory Coast | CI | Alphanumeric Sender ID | No | - | Free | If yo mark trans sam the s |
| Cook Islands | CK | Alphanumeric Sender ID | No | - | Free | - |
| Chile | CL | Numeric Sender ID | No | - | Free | - |
| Cameroon | CM | Alphanumeric Sender ID | Yes | - | Free | 1. A requ lang 2. If inco com on th prov own purc |

| | | | | | | registri certi |
|-----------------------|----|---------------------------|-----|-----|-------------------------------|-------------------|
| Colombia | CO | Numeric Sender ID | No | - | Free | - |
| Costa Rica | CR | Numeric Sender ID | No | - | Free | - |
| Cape Verde | CV | Alphanumeric Sender ID | No | - | Free | - |
| Curacao | CW | Alphanumeric Sender ID | No | - | Free | - |
| Cyprus | CY | Alphanumeric Sender ID | Yes | - | Free | - |
| Czech | CZ | Alphanumeric Sender ID | Yes | - | Log in for more details | - |
| Germany | DE | Alphanumeric Sender ID | No | Yes | Free | - |
| Djibouti | DJ | Alphanumeric Sender ID | No | - | Free | - |
| Denmark | DK | Alphanumeric Sender ID | No | Yes | Free | - |
| Dominica | DM | Alphanumeric Sender ID | No | - | Free | - |
| Dominican Republic | DO | Alphanumeric Sender ID | No | - | Free | - |
| Algeria | DZ | Alphanumeric Sender ID | Yes | - | Free | - |
| Ecuador | EC | Numeric Sender ID | Yes | - | Free | - |
| Estonia | EE | Alphanumeric Sender ID | No | - | Free | - |
| Egypt | EG | Alphanumeric Sender ID | Yes | - | Free | - |

| | | | | | | |
|----------------|----|------------------------|-----|-----|------|------------------------------------------------------------------|
| Eritrea | ER | Alphanumeric Sender ID | No | - | Free | - |
| Spain | ES | Alphanumeric Sender ID | No | Yes | Free | - |
| Ethiopia | ET | Alphanumeric Sender ID | Yes | - | Free | 1. A requ lang 2. If inco com on th prov own purc regis certi |
| Finland | FI | Alphanumeric Sender ID | No | - | Free | - |
| Fiji | FJ | Alphanumeric Sender ID | No | - | Free | - |
| Micronesia | FM | Numeric Sender ID | No | - | Free | - |
| Faroe Islands | FO | Alphanumeric Sender ID | No | - | Free | - |
| France | FR | Alphanumeric Sender ID | No | Yes | Free | - |
| Gabon | GA | Alphanumeric Sender ID | No | - | Free | - |
| United Kingdom | GB | Alphanumeric Sender ID | Yes | Yes | Free | 1. W pron prov metf out c |
| Grenada | GD | Alphanumeric Sender ID | No | - | Free | - |
| Georgia | GE | Alphanumeric | No | - | Free | - |

| | | Sender ID | | | | |
|-------------------|----|------------------------|-----|-----|------|---------------------------------------------------------------------------------|
| French Guiana | GF | Numeric Sender ID | No | - | Free | - |
| Ghana | GH | Alphanumeric Sender ID | Yes | - | Free | If the income is from the province, you must register and obtain a certificate. |
| Gibraltar | GI | Alphanumeric Sender ID | No | - | Free | - |
| Greenland | GL | Alphanumeric Sender ID | No | - | Free | - |
| Gambia | GM | Alphanumeric Sender ID | No | - | Free | - |
| Guinea | GN | Alphanumeric Sender ID | No | - | Free | - |
| Guadeloupe | GP | Alphanumeric Sender ID | No | - | Free | - |
| Equatorial Guinea | GQ | Alphanumeric Sender ID | No | - | Free | - |
| Greece | GR | Alphanumeric Sender ID | No | Yes | Free | - |
| Guatemala | GT | Numeric Sender ID | No | - | Free | - |
| Guam | GU | Numeric Sender ID | No | - | Free | - |
| Guinea-Bissau | GW | Alphanumeric Sender ID | No | - | Free | - |
| Guyana | GY | Alphanumeric Sender ID | No | - | Free | - |

| | | | | | | |
|-----------|----|------------------------|-----|-----|------|------------------------------------------------|
| Hong Kong | HK | Alphanumeric Sender ID | Yes | - | Free | - |
| Honduras | HN | Alphanumeric Sender ID | Yes | - | Free | - |
| Croatia | HR | Alphanumeric Sender ID | Yes | - | Free | - |
| Haiti | HT | Alphanumeric Sender ID | Yes | - | Free | - |
| Hungary | HU | Numeric Sender ID | No | - | Free | - |
| Indonesia | ID | Alphanumeric Sender ID | Yes | - | Free | 1. LC auth Plea using and sign; 2. A requ lang |
| Ireland | IE | Alphanumeric Sender ID | No | - | Free | - |
| Israel | IL | Alphanumeric Sender ID | No | - | Free | - |
| India | IN | Numeric Sender ID | No | - | Free | |
| Iraq | IQ | Alphanumeric Sender ID | No | - | Free | - |
| Iceland | IS | Alphanumeric Sender ID | No | - | Free | - |
| Italy | IT | Numeric Sender ID | No | Yes | Free | AGC Com of Ita regu traffi redu frau |

| | | | | | | |
|------------|----|---------------------------|-----|---|-------------------------------|---------------------------------------------------------------------------------------------------------------------------|
| | | | | | | start 15th alph inter long alph stric esta Italy AGC All a Italy num avoi risks |
| Jamaica | JM | Alphanumeric Sender ID | No | - | Free | - |
| Jordan | JO | Alphanumeric Sender ID | Yes | - | Free | - |
| Japan | JP | Alphanumeric Sender ID | No | - | Free | - |
| Kenya | KE | Alphanumeric Sender ID | Yes | - | Free | 1. A requ lang 2. If inco com on th prov own purc regis certi |
| Kyrgyzstan | KG | Alphanumeric Sender ID | No | - | Free | - |
| Cambodia | KH | Alphanumeric Sender ID | Yes | - | Log in for more details | - |
| Kiribati | KI | Numeric Sender ID | No | - | Free | - |

| | | | | | | |
|-----------------------|----|------------------------|-----|---|-------------------------------|-------------------------------------|
| Comoros | KM | Alphanumeric Sender ID | No | - | Free | - |
| Saint Kitts and Nevis | KN | Alphanumeric Sender ID | No | - | Free | - |
| South Korea | KR | Numeric Sender ID | No | - | Free | - |
| Kuwait | KW | Alphanumeric Sender ID | Yes | - | Free | LOA is re attac lette Engl |
| Cayman Islands | KY | Alphanumeric Sender ID | No | - | Free | - |
| Kazakhstan | KZ | Alphanumeric Sender ID | Yes | - | Log in for more details | - |
| Laos | LA | Alphanumeric Sender ID | No | - | Free | - |
| Lebanon | LB | Alphanumeric Sender ID | No | - | Free | - |
| Saint Lucia | LC | Alphanumeric Sender ID | No | - | Free | - |
| Liechtenstein | LI | Alphanumeric Sender ID | No | - | Free | - |
| Sri Lanka | LK | Alphanumeric Sender ID | Yes | - | Free | - |
| Liberia | LR | Alphanumeric Sender ID | No | - | Free | - |
| Lesotho | LS | Alphanumeric Sender ID | No | - | Free | - |
| Lithuania | LT | Alphanumeric Sender ID | No | - | Free | - |
| Luxembourg | LU | Alphanumeric | No | - | Free | - |

| | | Sender ID | | | | |
|------------------|----|------------------------|-----|---|------|---|
| Latvia | LV | Alphanumeric Sender ID | No | - | Free | - |
| Libya | LY | Alphanumeric Sender ID | Yes | - | Free | - |
| Morocco | MA | Alphanumeric Sender ID | Yes | - | Free | - |
| Monaco | MC | Alphanumeric Sender ID | No | - | Free | - |
| Moldova | MD | Alphanumeric Sender ID | No | - | Free | - |
| Montenegro | ME | Alphanumeric Sender ID | Yes | - | Free | - |
| Madagascar | MG | Alphanumeric Sender ID | No | - | Free | - |
| Marshall Islands | MH | Alphanumeric Sender ID | No | - | Free | - |
| Macedonia | MK | Alphanumeric Sender ID | No | - | Free | - |
| Mali | ML | Alphanumeric Sender ID | No | - | Free | - |
| Myanmar | MM | Alphanumeric Sender ID | Yes | - | Free | - |
| Mongolia | MN | Alphanumeric Sender ID | No | - | Free | - |
| Macao | MO | Alphanumeric Sender ID | No | - | Free | - |
| Mauritania | MR | Alphanumeric Sender ID | No | - | Free | - |
| Montserrat | MS | Alphanumeric Sender ID | No | - | Free | - |
| Malta | MT | Alphanumeric | No | - | Free | - |

| | | | | | | |
|---------------|----|------------------------|-----|-----|------|----------------------------------------------------------------------------------------------------------------------|
| | | Sender ID | | | | |
| Mauritius | MU | Alphanumeric Sender ID | No | - | Free | - |
| Maldives | MV | Alphanumeric Sender ID | No | - | Free | - |
| Malawi | MW | Alphanumeric Sender ID | Yes | - | Free | - |
| Mexico | MX | Numeric Sender ID | No | - | Free | Send over long |
| Malaysia | MY | Numeric Sender ID | No | Yes | Free | 1. Do not send all work hours. 2. At request of operator, guide specifications (including and block 2024 content) |
| Mozambique | MZ | Alphanumeric Sender ID | No | - | Free | - |
| Namibia | NA | Alphanumeric Sender ID | No | - | Free | - |
| New Caledonia | NC | Alphanumeric Sender ID | No | - | Free | - |
| Niger | NE | Alphanumeric Sender ID | No | - | Free | - |
| Nigeria | NG | Alphanumeric | Yes | - | Free | If the |

| | | Sender ID | | | | inco com on th prov own purc regis certi |
|---------------------|----|---------------------------|-----|-----|------|---------------------------------------------------------------|
| Nicaragua | NI | Numeric Sender ID | No | - | Free | - |
| Netherlands | NL | Alphanumeric Sender ID | No | Yes | Free | - |
| Norway | NO | Alphanumeric Sender ID | Yes | Yes | Free | - |
| Nepal | NP | Alphanumeric Sender ID | Yes | | Free | - |
| Nauru | NR | Numeric Sender ID | No | | Free | - |
| New Zealand | NZ | Numeric Sender ID | Yes | Yes | Free | Sen over and Sen cont |
| Oman | OM | Alphanumeric Sender ID | Yes | - | Free | LOA is re attac lette Engl |
| Panama | PA | Numeric Sender ID | No | - | Free | - |
| Peru | PE | Numeric Sender ID | No | - | Free | - |
| French Polynesia | PF | Alphanumeric Sender ID | No | - | Free | - |
| Papua New Guinea | PG | Alphanumeric Sender ID | No | - | Free | - |

| | | | | | | |
|---------------------------|----|-----------------------------------------------------------------------------------------|-----|-----|------|--------------------------------------------------------------------------------------------------|
| Philippines | PH | Alphanumeric Sender ID | Yes | Yes | Free | 1. Th supp such lette Send digit 2. LC auth Plea usin and sign: |
| Pakistan | PK | Alphanumeric Sender ID (Sender IDs will be overwritten to short code by some operators) | Yes | - | Free | - |
| Poland | PL | Alphanumeric Sender ID | No | Yes | Free | - |
| Saint Pierre and Miquelon | PM | Alphanumeric Sender ID | No | - | Free | - |
| Puerto Rico | PR | Numeric Sender ID | No | - | Free | - |
| Portugal | PT | Alphanumeric Sender ID | No | - | Free | - |
| Palau | PW | Alphanumeric Sender ID | No | - | Free | - |
| Paraguay | PY | Numeric Sender ID | No | - | Free | - |
| Qatar | QA | Alphanumeric Sender ID | Yes | - | Free | LOA is re attac lette Engl |
| Réunion Island | RE | Alphanumeric | No | - | Free | - |

| | | Sender ID | | | | |
|-----------------|----|------------------------|-----|-----|-------------------------|------------------------------------------------------------------------------------------------------------------------------------------------------------------------------------------------------------------|
| Romania | RO | Alphanumeric Sender ID | Yes | Yes | Log in for more details | LOA is re attac lette Engl |
| Serbia | RS | Alphanumeric Sender ID | Yes | - | Log in for more details | - |
| Saudi Arabia | SA | Alphanumeric Sender ID | Yes | - | Free | 1. Th requ offici attac with and in th mus (URI relat Sen 2. M mus e.g. 3. S: the c to se othe from SMS 10 P (GM 4. If from plea bran |
| Solomon Islands | SB | Alphanumeric Sender ID | No | - | Free | - |
| Seychelles | SC | Alphanumeric Sender ID | Yes | - | Free | - |
| Sudan | SD | Alphanumeric | Yes | - | Free | If the |

| | | Sender ID | | | | inco com on th prov own purc regis certi |
|--------------------------|----|---------------------------|-----|-----|--------------------------------------------------|-------------------------------------------------------------------------------|
| Sweden | SE | Alphanumeric Sender ID | No | Yes | Free | - |
| Singapore | SG | Alphanumeric Sender ID | Yes | - | Customers pay fees to carriers directly | 1. Ci mus of SI ("SS 2. LC auth Plea usin and sign |
| Slovenia | SI | Alphanumeric Sender ID | Yes | - | Free | - |
| Slovakia | SK | Alphanumeric Sender ID | No | - | Free | - |
| Sierra Leone | SL | Alphanumeric Sender ID | No | - | Free | - |
| San Marino | SM | Alphanumeric Sender ID | No | - | Free | - |
| Senegal | SN | Alphanumeric Sender ID | No | - | Free | - |
| Somalia | SO | Alphanumeric Sender ID | No | - | Free | - |
| Suriname | SR | Alphanumeric Sender ID | No | - | Free | - |
| Sao Tome and Principe | ST | Alphanumeric Sender ID | No | - | Free | - |
| | | | | | | |

| | | | | | | |
|--------------------------|----|------------------------|-----|---|------|-------------------------------------------------|
| El Salvador | SV | Numeric Sender ID | No | - | Free | - |
| Swaziland | SZ | Alphanumeric Sender ID | Yes | - | Free | If the inco com on th prov own purc regis certi |
| Turks and Caicos Islands | TC | Alphanumeric Sender ID | No | - | Free | - |
| Chad | TD | Alphanumeric Sender ID | No | - | Free | - |
| Togo | TG | Alphanumeric Sender ID | No | - | Free | - |
| Thailand | TH | Alphanumeric Sender ID | Yes | - | Free | LOA is re attac lette Engl |
| Tajikistan | TJ | Alphanumeric Sender ID | No | - | Free | - |
| East Timor | TL | Alphanumeric Sender ID | No | - | Free | - |
| Turkmenistan | TM | Alphanumeric Sender ID | Yes | - | Free | - |
| Tunisia | TN | Alphanumeric Sender ID | No | - | Free | -- |
| Tonga | TO | Alphanumeric Sender ID | No | - | Free | - |
| Turkey | TR | Alphanumeric Sender ID | Yes | - | Free | 1. LC auth Plea usin |

| | | | | | | |
|---------------------|----|-----------------------------------------------------------------------------------------|-----|----|------|-------------------------------------------------------------------------------------------------|
| | | | | | | and sign; 2. A requ lang 3. If inco com on th prov own purc regis certi |
| Trinidad and Tobago | TT | Alphanumeric Sender ID (Sender IDs will be overwritten to short code by some operators) | No | -- | Free | - |
| Taiwan | TW | Numeric Sender ID | No | - | Free | 1. Di requ ID w digit 2. Al cont whiti deliv |
| Tanzania | TZ | Alphanumeric Sender ID | Yes | - | Free | LOA is re attac lette Engl |
| Uganda | UA | Alphanumeric Sender ID | Yes | - | Free | If the inco com on th prov own purc |

| | | | | | | |
|----------------------------------------|----|------------------------------|-----|----------------------------------------------------------------------|-------------------------------|-----------------------------------------------------------------------------------------------------------------------------------------------------------------------------------|
| | | | | | | regist certi |
| United States | US | Toll-Free Number (TFN) | Yes | No, SMS content needs to be whitelisted by Tencent | Log in for more details | 1. Yo excl Send does cust 2. If type OTF subr OTF Marl sepa reco will a Send ensu diffe 3. It a br cont [Ten is 12 |
| Uruguay | UY | Numeric Sender ID | No | - | Free | - |
| Uzbekistan | UZ | Alphanumeric Sender ID | No | - | Free | - |
| Saint Vincent and the Grenadines | VC | Alphanumeric Sender ID | No | - | Free | - |
| Venezuela | VE | Alphanumeric Sender ID | Yes | - | Free | - |
| Virgin Islands, British | VG | Numeric Sender ID | No | - | Free | - |
| Vietnam | VN | Alphanumeric Sender ID | Yes | - | | 1. LC auth Plea usin |

| | | | | | | |
|---------|----|---------------------------|----|---|------|-----------------------------------------------------------------------------------------------------------------------------------------------------------------------------------------------------------------------------------------------------------------------------------------------------------------------------------|
| | | | | | | and sign; 2. PI busi Vietr 3. If diffe nam plea bran (owr cont trad 4. SI (Vie mus all m be fi lette cont Vie and can regis 5. W SMS prov SMS scre OTF scre of hc OTF Fina are r mus for r cate guar may and |
| Vanuatu | VU | Alphanumeric Sender ID | No | - | Free | - |
| Samoa | WS | Alphanumeric | No | - | Free | - |

| | | Sender ID | | | | |
|------------------------------|----|------------------------|-----|---|-------------------------|-------------------------------------------------|
| Yemen | YE | Alphanumeric Sender ID | Yes | - | Log in for more details | - |
| Mayotte | YT | Alphanumeric Sender ID | No | - | Free | - |
| South Africa | ZA | Numeric Sender ID | No | - | Free | - |
| Zambia | ZM | Alphanumeric Sender ID | Yes | - | Free | If the inco com on th prov own purc regis certi |
| Zimbabwe | ZW | Alphanumeric Sender ID | No | - | Free | - |
| Kosovo | XK | Alphanumeric Sender ID | No | - | Free | - |
| United States Virgin Islands | VI | Alphanumeric Sender ID | No | - | Free | - |
| Sint Maarten (Dutch Part) | SX | Alphanumeric Sender ID | No | - | Free | - |
| South Sudan | SS | Alphanumeric Sender ID | Yes | - | Free | - |
| Palestine | PS | Alphanumeric Sender ID | Yes | - | Free | - |
| Martinique | MQ | Alphanumeric Sender ID | No | - | Free | - |
| Northern Mariana Islands | MP | Alphanumeric Sender ID | No | - | Free | - |
| Netherlands Antilles | AN | Alphanumeric Sender ID | No | - | Free | - |

| | | | | | | |
|---------------------|----|------------------------|----|---|------|---|
| Guernsey | GG | Alphanumeric Sender ID | No | - | Free | - |
| Isle of Man | IM | Alphanumeric Sender ID | No | - | Free | - |
| Jersey | JE | Alphanumeric Sender ID | No | - | Free | - |
| Norfolk Island | NF | Alphanumeric Sender ID | No | - | Free | - |
| Tuvalu | TV | Alphanumeric Sender ID | No | - | Free | - |
| Ascension Island | AC | Alphanumeric Sender ID | No | - | Free | - |
| Caribisch Nederland | BQ | Alphanumeric Sender ID | No | - | Free | - |
| Mayotte | YT | Alphanumeric Sender ID | No | - | Free | - |

Sender ID Reporting Method

Log in to the console and submit a registration application at the [Global SMS > Sender ID Applications](#).

Global SMS Pricing

Billing Overview

Last updated : 2024-01-18 16:21:35

SMS Length Calculation Rule

S

MS le

ngth = number of characters in the signature + number of characters in the body. A single SMS message can contain up to 500 characters.

Note :

Signature is optional for global SMS.

SMS containing English characters only

A standard GSM character is calculated as **1 character**, while an extended GSM character is calculated as **2 characters**.

| Category | Character List |
|---------------------|---------------------------------------------------------------------------------------------------------------------------------|
| Standard characters | !"#\$%&'()*+,-./:;<=>?@_`¡¢£¥¦§¨ª«¬®¯°±²³´µ¶·¸¹º»¼½¾¿ÀÁÂÃÄÅÆÇÈÉÊËÌÍÎÏÐÑÒÓÔÕÖ×ØÙÚÛÜÝÞßàáâãäåæçèéêëìíîïðñòóôõö÷øùúûüýþÿΔΦΓΛΩΠΨΣΘΞ |
| Extended characters | ^ € { } [] ~ \ |

If an SMS message contains 160 characters or less, it will be billed as one message; otherwise, it will be billed as multiple messages based on the standard of 153 characters per message.

For example, if an SMS message contains 320 characters, it will be billed as 3 messages (153 + 153 + 14 characters).

SMS containing non-English characters

One Chinese character, letter, digit, punctuation mark (both fullwidth and halfwidth forms), or space will be calculated as **1 character**.

If an SMS message contains 70 characters or less, it will be billed as one message; otherwise, it will be billed as multiple messages based on the standard of 67 characters per message.

For example, if an SMS message contains 150 characters, it will be billed as 3 messages (67 + 67 + 16 characters).

Billing Mode

Global SMS is daily pay-as-you-go by message length on a per message basis. **General vouchers do not apply.** The payment for a day is deducted at 8:00 am the next day as detailed in the bill. Global SMS is available in over 200 countries and regions by which the prices vary. For more information, please see [Global SMS Pricing Overview](#).

Billing Details

Before the 3rd day of each month, Tencent Cloud will provide you with a detailed global SMS bill for last month. You can click **Details** for the SMS service in Tencent Cloud Console > **Billing Center** > **Transactions** to view the billing details. You can also export reports for financial reporting and bookkeeping.

Payment Overdue

Global SMS is daily pay-as-you-go. The payment for a day is deducted at 8:00 am the next day. If payment fails due to insufficient balance, you will receive a payment overdue notification via SMS. If you fail to pay the past due charges within 12 hours, the service will be suspended.

The service will resume when you have sufficient balance in your Tencent Cloud account. You shall be responsible for any consequences caused by service suspension due to overdue payment.

Pricing

Last updated : 2024-12-26 18:11:23

Note:

Vouchers does not apply to SMS products.

Pricing for Global SMS

Global SMS is daily [pay-as-you-go](#). The prices in the table are in US dollars.

Note:

Due to the rates adjustment by carriers in certain countries/regions, Tencent Cloud will adjust Global SMS prices for those affected countries/regions from **00:00:00 Beijing time on July 1, 2024**. For details, please refer to [Price Adjustment of Global SMS in Certain Countries/Regions](#).

[Price Adjustment of Global SMS in Certain Countries/Regions](#).

| Country/Region | Code | Country/Region Code | Unit price excluding tax (USD/item) |
|----------------------|------|---------------------|-------------------------------------|
| Ascension Island | AC | 247 | 0.325 |
| Andorra | AD | 376 | 0.165 |
| United Arab Emirates | AE | 971 | 0.0969 |
| Afghanistan | AF | 93 | 0.326 |
| Antigua and Barbuda | AG | 1268 | 0.221 |
| Anguilla | AI | 1264 | 0.184 |
| Albania | AL | 355 | 0.095 |
| Armenia | AM | 374 | 0.23 |
| Netherlands Antilles | AN | 599 | 0.325 |
| Angola | AO | 244 | 0.11 |
| Argentina | AR | 54 | 0.089 |
| American Samoa | AS | 1684 | 0.115 |
| Austria | AT | 43 | 0.095 |
| Australia | AU | 61 | 0.05 |

| | | | |
|----------------------------------|----|------|--------|
| Aruba | AW | 297 | 0.184 |
| Azerbaijan | AZ | 994 | 0.384 |
| Bosnia and Herzegovina | BA | 387 | 0.0874 |
| Barbados | BB | 1246 | 0.198 |
| Bangladesh | BD | 880 | 0.288 |
| Belgium | BE | 32 | 0.112 |
| Burkina Faso | BF | 226 | 0.156 |
| Bulgaria | BG | 359 | 0.15 |
| Bahrain | BH | 973 | 0.0385 |
| Burundi | BI | 257 | 0.296 |
| Benin | BJ | 229 | 0.166 |
| Bermuda | BM | 1441 | 0.169 |
| Brunei | BN | 673 | 0.0585 |
| Bolivia | BO | 591 | 0.228 |
| Caribisch Nederland | BQ | 599 | 0.186 |
| Brazil | BR | 55 | 0.0165 |
| Bahamas | BS | 1242 | 0.0638 |
| Bhutan | BT | 975 | 0.268 |
| Botswana | BW | 267 | 0.098 |
| Belarus | BY | 375 | 0.242 |
| Belize | BZ | 501 | 0.298 |
| Canada | CA | 1 | 0.0158 |
| Democratic Republic of the Congo | CD | 243 | 0.282 |
| Central African Republic | CF | 236 | 0.09 |
| Republic Of The Congo | CG | 242 | 0.282 |

| | | | |
|--------------------|----|------|--------|
| Switzerland | CH | 41 | 0.058 |
| Ivory Coast | CI | 225 | 0.231 |
| Cook Islands | CK | 682 | 0.056 |
| Chile | CL | 56 | 0.05 |
| Cameroon | CM | 237 | 0.178 |
| Colombia | CO | 57 | 0.045 |
| Costa Rica | CR | 506 | 0.068 |
| Cape Verde | CV | 238 | 0.155 |
| Curacao | CW | 599 | 0.184 |
| Cyprus | CY | 357 | 0.0328 |
| Czech | CZ | 420 | 0.076 |
| Germany | DE | 49 | 0.094 |
| Djibouti | DJ | 253 | 0.15 |
| Denmark | DK | 45 | 0.0587 |
| Dominica | DM | 1767 | 0.184 |
| Dominican Republic | DO | 1809 | 0.188 |
| Algeria | DZ | 213 | 0.24 |
| Ecuador | EC | 593 | 0.192 |
| Estonia | EE | 372 | 0.062 |
| Egypt | EG | 20 | 0.245 |
| Western Sahara | EH | 212 | 0.28 |
| Eritrea | ER | 291 | 0.192 |
| Spain | ES | 34 | 0.046 |
| Ethiopia | ET | 251 | 0.338 |
| Finland | FI | 358 | 0.076 |
| | | | |

| | | | |
|-------------------|----|------|--------|
| Fiji | FJ | 679 | 0.188 |
| Micronesia | FM | 691 | 0.15 |
| Faroe Islands | FO | 298 | 0.0852 |
| France | FR | 33 | 0.076 |
| Gabon | GA | 241 | 0.228 |
| United Kingdom | GB | 44 | 0.046 |
| Grenada | GD | 1473 | 0.204 |
| Georgia | GE | 995 | 0.178 |
| French Guiana | GF | 594 | 0.184 |
| Guernsey | GG | 826 | 0.188 |
| Ghana | GH | 233 | 0.184 |
| Gibraltar | GI | 350 | 0.138 |
| Greenland | GL | 299 | 0.015 |
| Gambia | GM | 220 | 0.195 |
| Guinea | GN | 224 | 0.165 |
| Guadeloupe | GP | 590 | 0.184 |
| Equatorial Guinea | GQ | 240 | 0.22 |
| Greece | GR | 30 | 0.063 |
| Guatemala | GT | 502 | 0.184 |
| Guam | GU | 1671 | 0.06 |
| Guinea-Bissau | GW | 245 | 0.165 |
| Guyana | GY | 592 | 0.214 |
| Hong Kong, China | HK | 852 | 0.06 |
| Honduras | HN | 504 | 0.118 |
| Croatia | HR | 385 | 0.127 |
| | | | |

| | | | |
|-----------------------|----|------|--------|
| Haiti | HT | 509 | 0.254 |
| Hungary | HU | 36 | 0.098 |
| Indonesia | ID | 62 | 0.385 |
| Ireland | IE | 353 | 0.066 |
| Israel | IL | 972 | 0.194 |
| Isle of Man | IM | 833 | 0.188 |
| India | IN | 91 | 0.062 |
| Iraq | IQ | 964 | 0.276 |
| Iceland | IS | 354 | 0.0868 |
| Italy | IT | 39 | 0.062 |
| Jersey | JE | 832 | 0.188 |
| Jamaica | JM | 1876 | 0.23 |
| Jordan | JO | 962 | 0.23 |
| Japan | JP | 81 | 0.06 |
| Kenya | KE | 254 | 0.16 |
| Kyrgyzstan | KG | 996 | 0.298 |
| Cambodia | KH | 855 | 0.217 |
| Kiribati | KI | 686 | 0.068 |
| Comoros | KM | 269 | 0.239 |
| Saint Kitts and Nevis | KN | 1869 | 0.184 |
| South Korea | KR | 82 | 0.034 |
| Kuwait | KW | 965 | 0.245 |
| Cayman Islands | KY | 1345 | 0.184 |
| Kazakhstan | KZ | 7 | 0.275 |
| Laos | LA | 856 | 0.265 |
| | | | |

| | | | |
|--------------------------|----|------|--------|
| Lebanon | LB | 961 | 0.298 |
| Saint Lucia | LC | 1758 | 0.184 |
| Liechtenstein | LI | 423 | 0.091 |
| Sri Lanka | LK | 94 | 0.312 |
| Liberia | LR | 231 | 0.236 |
| Lesotho | LS | 266 | 0.166 |
| Lithuania | LT | 370 | 0.058 |
| Luxembourg | LU | 352 | 0.09 |
| Latvia | LV | 371 | 0.065 |
| Libya | LY | 218 | 0.288 |
| Morocco | MA | 212 | 0.228 |
| Monaco | MC | 377 | 0.172 |
| Moldova | MD | 373 | 0.12 |
| Montenegro | ME | 382 | 0.125 |
| Madagascar | MG | 261 | 0.398 |
| Marshall Islands | MH | 692 | 0.194 |
| Macedonia | MK | 389 | 0.042 |
| Mali | ML | 223 | 0.178 |
| Myanmar | MM | 95 | 0.256 |
| Mongolia | MN | 976 | 0.266 |
| Macau, China | MO | 853 | 0.0288 |
| Northern Mariana Islands | MP | 1670 | 0.2 |
| Martinique | MQ | 596 | 0.188 |
| Mauritania | MR | 222 | 0.282 |
| Montserrat | MS | 1664 | 0.185 |
| | | | |

| | | | |
|------------------|----|-----|-------|
| Malta | MT | 356 | 0.074 |
| Mauritius | MU | 230 | 0.179 |
| Maldives | MV | 960 | 0.208 |
| Malawi | MW | 265 | 0.282 |
| Mexico | MX | 52 | 0.038 |
| Malaysia | MY | 60 | 0.24 |
| Mozambique | MZ | 258 | 0.135 |
| Namibia | NA | 264 | 0.042 |
| New Caledonia | NC | 687 | 0.22 |
| Niger | NE | 227 | 0.336 |
| Norfolk Island | NF | 574 | 0.188 |
| Nigeria | NG | 234 | 0.242 |
| Nicaragua | NI | 505 | 0.098 |
| Netherlands | NL | 31 | 0.11 |
| Norway | NO | 47 | 0.072 |
| Nepal | NP | 977 | 0.28 |
| Nauru | NR | 674 | 0.275 |
| Niue | NU | 683 | 0.298 |
| New Zealand | NZ | 64 | 0.089 |
| Oman | OM | 968 | 0.12 |
| Panama | PA | 507 | 0.184 |
| Peru | PE | 51 | 0.098 |
| French Polynesia | PF | 689 | 0.168 |
| Papua New Guinea | PG | 675 | 0.228 |
| Philippines | PH | 63 | 0.2 |
| | | | |

| | | | |
|---------------------------|----|------|-------|
| Pakistan | PK | 92 | 0.288 |
| Poland | PL | 48 | 0.026 |
| Saint Pierre and Miquelon | PM | 508 | 0.158 |
| Puerto Rico | PR | 1787 | 0.156 |
| Palestinian Territory | PS | 970 | 0.388 |
| Portugal | PT | 351 | 0.042 |
| Palau | PW | 680 | 0.098 |
| Paraguay | PY | 595 | 0.092 |
| Qatar | QA | 974 | 0.218 |
| Réunion Island | RE | 262 | 0.22 |
| Romania | RO | 40 | 0.076 |
| Serbia | RS | 381 | 0.32 |
| Rwanda | RW | 250 | 0.282 |
| Saudi Arabia | SA | 966 | 0.156 |
| Solomon Islands | SB | 677 | 0.058 |
| Seychelles | SC | 248 | 0.088 |
| Sudan | SD | 249 | 0.29 |
| Sweden | SE | 46 | 0.058 |
| Singapore | SG | 65 | 0.044 |
| Slovenia | SI | 386 | 0.188 |
| Slovakia | SK | 421 | 0.068 |
| Sierra Leone | SL | 232 | 0.22 |
| San Marino | SM | 378 | 0.198 |
| Senegal | SN | 221 | 0.32 |
| Somalia | SO | 252 | 0.3 |
| | | | |

| | | | |
|---------------------------|----|------|--------|
| Suriname | SR | 597 | 0.19 |
| South Sudan | SS | 211 | 0.11 |
| Sao Tome and Principe | ST | 239 | 0.12 |
| El Salvador | SV | 503 | 0.23 |
| Sint Maarten (Dutch Part) | SX | 1721 | 0.1584 |
| Swaziland | SZ | 268 | 0.0964 |
| Turks and Caicos Islands | TC | 1649 | 0.184 |
| Chad | TD | 235 | 0.284 |
| Togo | TG | 228 | 0.168 |
| Thailand | TH | 66 | 0.015 |
| Tajikistan | TJ | 992 | 0.398 |
| Tokelau | TK | 690 | 0.298 |
| East Timor | TL | 670 | 0.163 |
| Turkmenistan | TM | 993 | 0.24 |
| Tunisia | TN | 216 | 0.34 |
| Tonga | TO | 676 | 0.19 |
| Türkiye | TR | 90 | 0.011 |
| Trinidad and Tobago | TT | 1868 | 0.184 |
| Tuvalu | TV | 688 | 0.298 |
| Taiwan, China | TW | 886 | 0.045 |
| Tanzania | TZ | 255 | 0.288 |
| Uganda | UG | 256 | 0.32 |
| United States | US | 1 | 0.0078 |
| Uruguay | UY | 598 | 0.088 |
| Uzbekistan | UZ | 998 | 0.346 |
| | | | |

| | | | |
|----------------------------------|----|------|--------|
| Saint Vincent and The Grenadines | VC | 1784 | 0.184 |
| Venezuela | VE | 58 | 0.13 |
| Virgin Islands, British | VG | 1284 | 0.19 |
| Virgin Islands, US | VI | 1340 | 0.0784 |
| Vietnam | VN | 84 | 0.142 |
| Vanuatu | VU | 678 | 0.165 |
| Samoa | WS | 685 | 0.0862 |
| Kosovo | XK | 383 | 0.24 |
| Yemen | YE | 967 | 0.3 |
| Mayotte | YT | 269 | 0.25 |
| South Africa | ZA | 27 | 0.096 |
| Zambia | ZM | 260 | 0.286 |
| Zimbabwe | ZW | 263 | 0.25 |

Getting Started

Last updated : 2024-05-24 17:06:31

This document helps you quickly get started with the Global SMS service by show you how an organization user sends the following message “Your verification code is 1234 (valid for 5 minutes). For account safety, don't forward the code to others.” to mobile numbers outside the Chinese mainland. For more SMS concepts, see [Glossary](#).

Step 1. Activate the SMS service

Signing up for Tencent Cloud account

If you don't have a Tencent Cloud account yet, you need to [sign up for a Tencent Cloud account](#) and [verify your organizational identity](#).

If you already have a Tencent Cloud account and have verified your identity, go directly to the next step.

Applying for activation of SMS

Note :

When logging in to the SMS console for the first time, you need to apply to activate the SMS service.

1. Log in to the SMS console, click **I've read and agree to Tencent Cloud SMS Terms of Service**, and click **Access** to activate the service.
2. After activation, enter the SMS console and follow the [overview page](#) New User Configuration Guide to apply for an SMS template and send SMS messages.

Step 2. Check daily sending limit

o reduce the loss caused by [SMS bombing \(cheating\)](#) , the platform has set a default daily limit for Global SMS.

Please go to the overview page and check whether the initial value of the [Global SMS Daily Sending Limit \(Account Level\)](#) module meets your current business needs.

On the [overview page](#)> **Quick Start** > **Global SMS** > **Check daily sending limit** > **Global SMS Daily Sending Limit (Account Level)**.

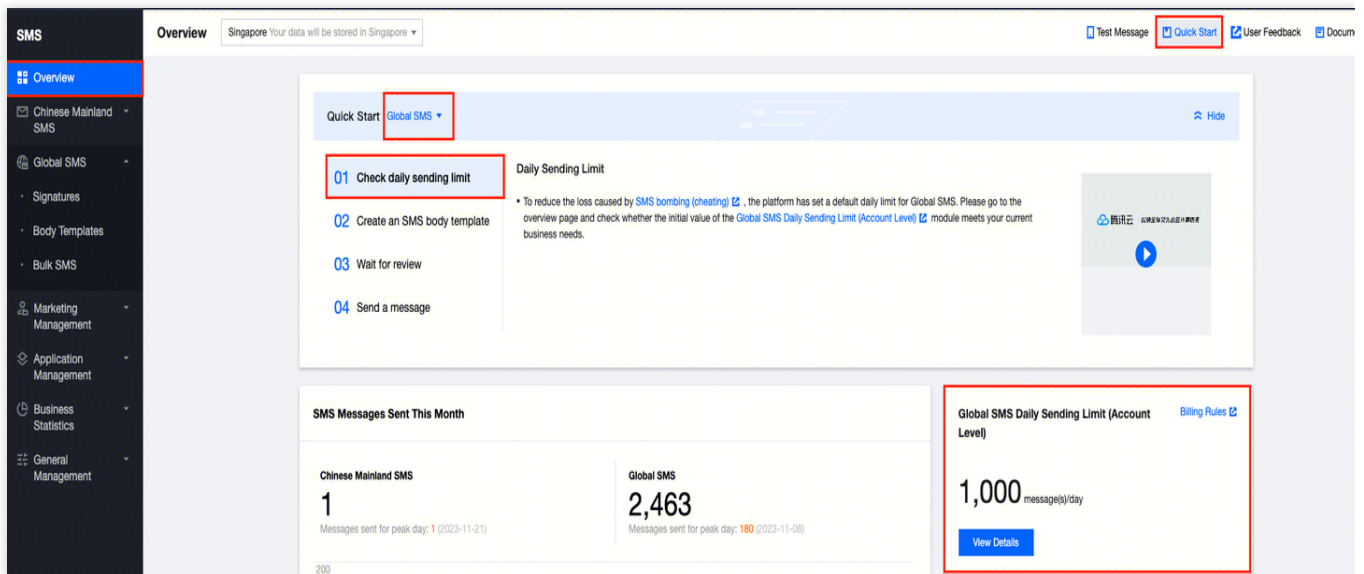

Step 3. Configure SMS content

A complete SMS message consists of SMS signature and SMS body. You can set different body templates as needed and then combine a signature and a body into the final SMS content: `[SMS signature] SMS body`. After an SMS signature or template is submitted, it will be reviewed within two hours generally. You can set your mobile number and email address to receive review result notifications.

Signature is optional for Global SMS. This document uses no signature as an example.

Create a text template

1. On the [overview page](#) > [New User Configuration Guide](#) > [Global SMS](#) > Click [Create Template](#).

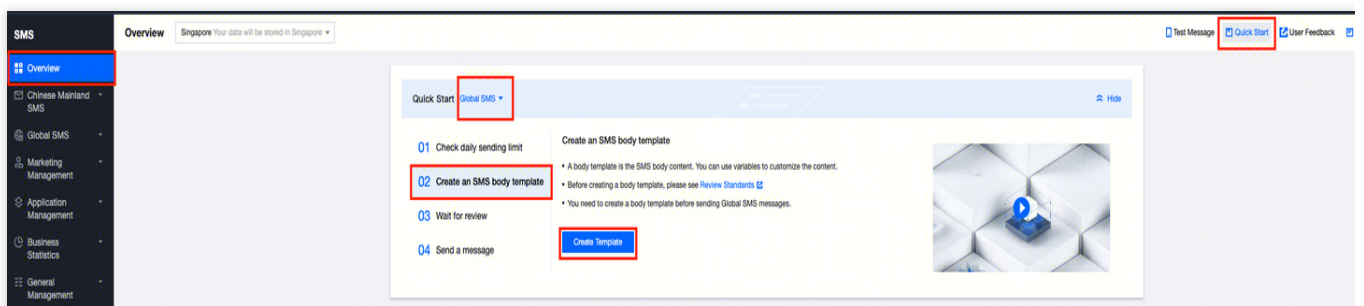

2. Set the following parameters according to your business needs and the [body template review standards](#):

Template Name: enter Verification Code.

SMS Type: select **OTP SMS**.

SMS Content: enter `Your verification code is {1}(valid for {2} minutes). For account safety, don't forward the code to others.`

Click **OK**.

Please wait for the body template review. The body template will be available only after its status changes to **Approved**.

Step 4. Wait for approval

You can check the latest application template review status, and the text template can be used only when its status changes to "approved."

After an SMS signature or body template is submitted, it will be reviewed within two hours generally. You can set your mobile number and email address to receive review result notifications.

You can view the status of all templates in Global SMS > [Text Templates](#).

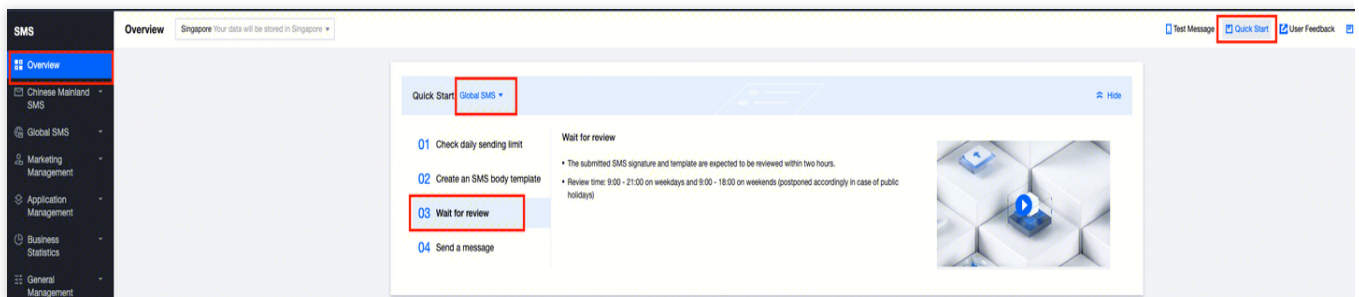

Step 5. Send SMS messages

Before sending an SMS message, make sure the SMS signature and body template have been approved.

You can send SMS messages through the console or API. This document uses the console as an example.

Console SMS sending: No development is required. Upload the mobile phone numbers that need to send SMS messages in the SMS console and send them by yourself.

API SMS sending: For those with development capabilities, integrate the SMS service into the business system and send SMS messages through the API interface.

On the overview page, [New User Configuration Guide](#) > [Global SMS](#) > [Send SMS](#). This article takes console SMS sending as an example.

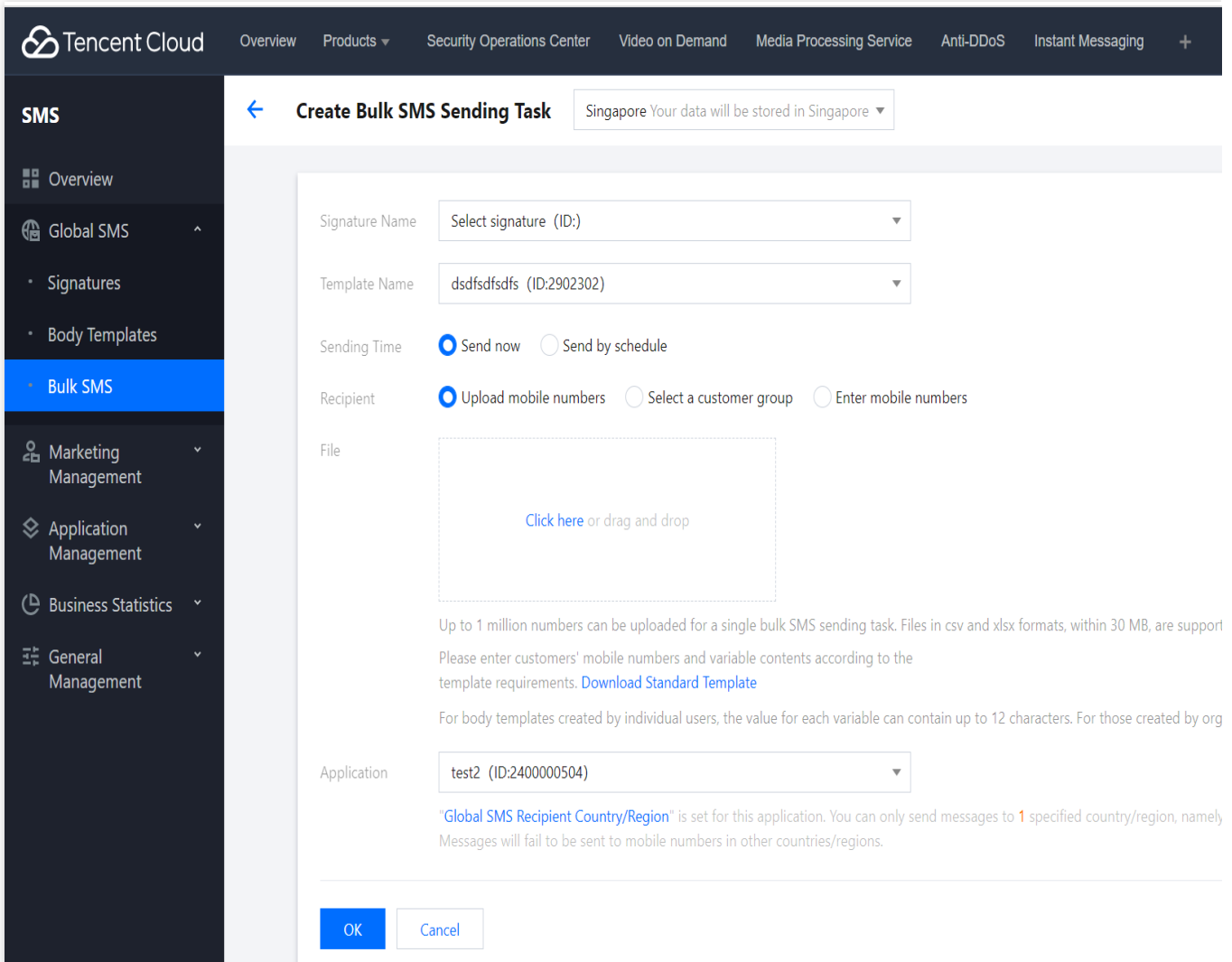
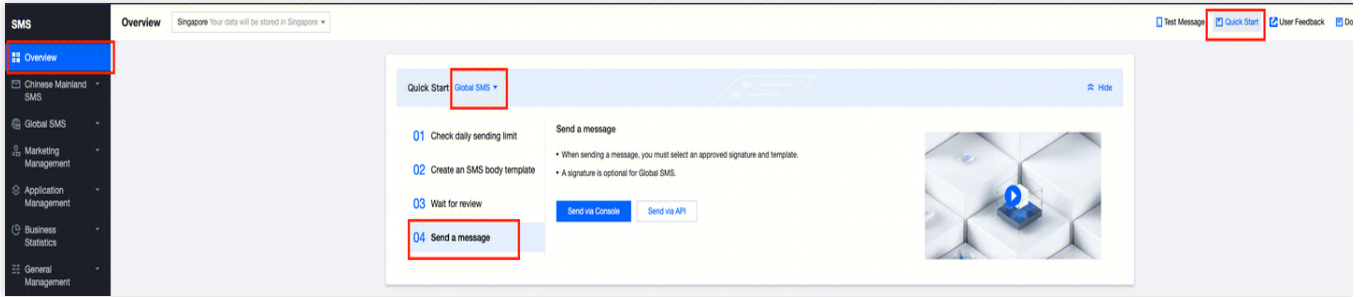

Configure the following parameters as needed:

Signature Name: signature is optional for Global SMS.

Template Name: select the template **Verification Code** created in the [Creating a body template](#) step.

Sending Time: select **Send now**.

Recipient: select **Upload mobile numbers**, click **Download Standard Template**, enter the recipient's mobile number and custom SMS content in the form, and click **Click here** to upload it. The maximum form size supported is

30 MB.

| Template Description | Recipient's Mobile Number | SMS Content Variable 1 | SMS Content Variable 2 |
|----------------------|--------------------------------------------------------------------------------------------------------------------------------------------------------------------------------------------------------------------------------------------|---------------------------------------------------------------------------------------------------------------------|---------------------------------------------------------------------------------------------------------------------|
| Sample | 9xxxxxxx | 1234 | 5 |
| Instructions | Please enter the mobile numbers of recipients. All the mobile numbers in one single SMS sending task must be registered outside the Chinese mainland. The cells need to be in a regular format, i.e., without any specific number formats. | Please enter the first custom variable content according to the body template, i.e., replacing {1} in the template. | Please enter the first custom variable content according to the body template, i.e., replacing {2} in the template. |

There are three types of recipients as follows:

| Recipient | Description | Variable Template |
|-------------------------|----------------------------------------------------------------------------------------------------------------------------------------------------------------------------------------------------------------------------------------------------------------------------------------------------------------------------------------------------------------------------------------------------|-------------------|
| Upload mobile numbers | You can upload up to 1 million mobile numbers in a CSV or XLSX file of up to 30 MB in size for each bulk SMS sending task. In an SMS body template created by an individual user, each variable can contain up to 12 characters. There is no limit on the length of variable values for organizational users. | Supported |
| Select a customer group | Click Customer Group and select a number group that has been created in Customer Group. For more information, please see Customer Management. Note: you cannot select a template with variables for Template Name. | Not supported |
| Enter mobile numbers | Enter up to 100 mobile numbers and separate them by pressing the Enter key (one number per line). For mobile numbers outside the Chinese mainland, please enter the country/region code + mobile number. For example, when the country/region code is 852 and the mobile number is 6666XXXX, enter 8526666XXXX. Note: you cannot select a template with variables for Template Name.. | Not supported |

Application: select the application that needs to send the SMS. For more information, please see [Creating Application](#).

1. Click **OK**.

2. Check the number of recipients, indicate your consent to the prompt about fees, and click **Send**.

You can view the task status in the “Sending Records” list. The status **Sent** indicates the task has been completed.

Step 6. View SMS delivery result

You can view the SMS delivery result in the following ways:

On the **Global SMS > Bulk SMS** page, click **Details & Receipt Analytics** on the line of the target task to view its detailed record and receipt analysis.

Select **Business Statistics > Global SMS** and you can filter and view the statistics and relevant analysis of Global SMS by application, signature, body template, and time.