

Tencent Cloud TCHouse-D

Cloud Ecosystem

Product Documentation



Copyright Notice

©2013-2025 Tencent Cloud. All rights reserved.

Copyright in this document is exclusively owned by Tencent Cloud. You must not reproduce, modify, copy or distribute in any way, in whole or in part, the contents of this document without Tencent Cloud's the prior written consent.

Trademark Notice



All trademarks associated with Tencent Cloud and its services are owned by the Tencent corporate group, including its parent, subsidiaries and affiliated companies, as the case may be. Trademarks of third parties referred to in this document are owned by their respective proprietors.

Service Statement

This document is intended to provide users with general information about Tencent Cloud's products and services only and does not form part of Tencent Cloud's terms and conditions. Tencent Cloud's products or services are subject to change. Specific products and services and the standards applicable to them are exclusively provided for in Tencent Cloud's applicable terms and conditions.

Contents

Cloud Ecosystem

Granting CAM Policies to Sub-accounts

Query Acceleration for Tencent Cloud DLC

Cloud Ecosystem

Granting CAM Policies to Sub-accounts

Last updated : 2024-12-13 11:22:11

Note:

The following steps require using either the root account or a sub-account with full CAM read and write permissions.

Granting Policies to Sub-accounts

Using the root account or a sub-account with full CAM read and write permissions, go to the Tencent Cloud [CAM - User List](#) page, find the sub-account that needs to be granted CAM policies, and click **Authorize**.

User List

How to view more information?
CAM protects the security of your sensitive information. You can click the drop-down button [▶] on the left side of the list to view more information about the user, such as identity security status, groups the user has joined, and message subscription. You can also click the username to view or edit the user information.

Create User More

Search by username/ID/SecretId/mobile/email/remarks (s)

Username	User Type	Account ID	Creation Time	Associated Info	Operation
[Avatar] Username	Root Account	[Avatar] Account ID	2022-02-09 16:04:03	[Avatar] Associated Info	Authorize More
[Avatar] Username	Sub-user	[Avatar] Account ID	2024-06-18 15:25:39	[Avatar] Associated Info	Authorize More
[Avatar] Username	Sub-user	[Avatar] Account ID	2022-02-10 16:17:23	[Avatar] Associated Info	Authorize More

0 selected, 3 in total

20 / page 1 / 1 page

Appendix: Supplementary Policy Explanation

Associate Policy

Select Policies (901 Total)

Policy Name	Policy Type
<input type="checkbox"/> AdministratorAccess This policy allows you to manage all users under your account and ...	Preset Policy
<input type="checkbox"/> QCloudResourceFullAccess This policy allows you to manage all cloud assets in your account...	Preset Policy
<input type="checkbox"/> ReadOnlyAccess This policy authorizes you with the read-only access to all cloud as...	Preset Policy
<input type="checkbox"/> QCloudFinanceFullAccess This policy allows you to manage all financial items in your account...	Preset Policy
<input type="checkbox"/> QcloudAccessForASRoleInAutomationTools	

Support for holding shift key down for multiple selection

OK

Cancel

0 selected

Policy Name	Policy Type
-------------	-------------

Tencent Cloud TCHouse-D common preset policies are as follows:

Preset Policy

Tencent Cloud TCHouse-D Common predefined policies are as follows:

Purpose of Policy	Policy Description	Use of Policy
QcloudCdworisFullAccess	Tencent Cloud TCHouse-D Full Read-Write Access	Full read-write access permission for users
QcloudCamFullAccess	Full read-write access to Cloud Access Management (CAM)	Used to open the lake warehouse in Tencent Cloud TCHouse-D cluster
QcloudBDAIFullAccess	Full read-write access to Big Data AI Assistant (BDAI)	For using Big Data AI Assistant

In the pop-up window, click

On the CAM console's [Access Control - Policy](#) page, click **Create a custom policy** to create a new policy.

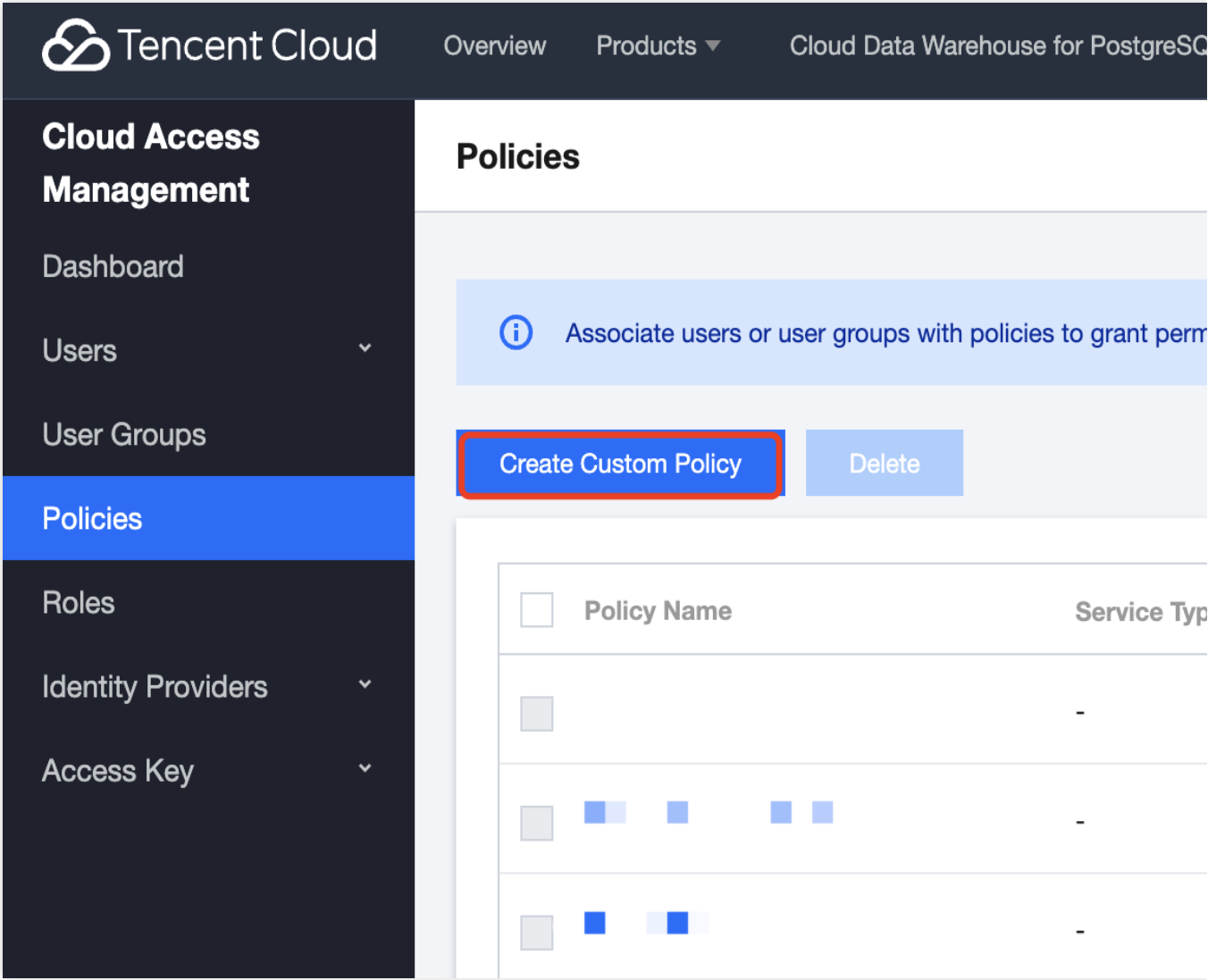

In the pop-up window, click **Create by Policy Syntax** to enter the edit policy page.

Select Policy Creation Method



Create by Policy Generator

Select service and actions from the list to auto-generate policy syntax



Create by Policy Syntax

Write policy syntax to generate policies



Authorize by Tag

Grant permissions of resources under certain tags to users or user groups



On the Create by Policy Syntax page, select **Blank Template** and click Next.

←

Create by Policy Syntax

1

Select Policy Template

>

2

Edit Policy

Template Type: All Templates

Search policy name

Q

Select a template type

All Templates (901 Total)

☐

Blank Template

☐

AdministratorAccess

This policy allows you to manage all users under your account and their permissions, financial information...

☐

QCloudResourceFullAccess

This policy allows you to manage all cloud assets in your account (Except all permissions to use CAM...

☐

ReadOnlyAccess

This policy authorizes you with the read-only access to all cloud assets that support authentication at A...

☐

QCloudFinanceFullAccess

This policy allows you to manage all financial items in your account, such as payment and billing.

☐

QcloudAccessForASRoleInAuto...

Auto Scaling operation permission for TAT.

☐

QcloudAccessForCLSRoleInAcc...

This policy is for the CLS service role (CLS_QCSRole) to be associated and used by CLS to access other...

☐

QcloudAccessForCLSRoleInCDB

This policy is for the CLS service role(CLS_QCSRole) to be associated and used by CLS to access CDB...

☐

QcloudAccessForCLSRoleInCis...

This policy allows CLS(Cloud Log Service) DataTransform task to play a role as the clients...

Next

In the template, enter the policy name and description. After completing, click **Complete** to successfully create a custom policy.

[←](#) Create by Policy Syntax

✓ Select Policy Template

 >

2 Edit Policy

Policy Name * Modify the policy name on demand

After the policy is created, its name cannot be modified.

Description

Policy Content [Use Legacy Version](#)

```
1 {  
2   "version": "2.0",  
3   "statement": []  
4 }
```

Modify the policy content on demand

Query Acceleration for Tencent Cloud DLC

Last updated : 2024-11-05 16:33:46

This document describes how to accelerate queries against Tencent Cloud Data Lake Compute (DLC) through Tencent Cloud TCHouse-D (TCHouse-D).

Prerequisites

The [Tencent Cloud TCHouse-D](#) cluster has been purchased.

The [Tencent Cloud DLC](#) service has been activated.

Note:

1. Cross-region or cross-federal DLC is not supported. Please plan your environment properly to ensure that the Tencent Cloud TCHouse-D and DLC are in the same region and the same VPC.
2. **The DLC native tables created before June 12, 2024 cannot be queried (with the storage path lakefs://**, because this format is not compatible currently).** It only supports the DLC native tables (with storage path cosn://**) created after June 12, 2024 and all the DLC external tables.

Operation Steps

1. Enter the [Tencent Cloud TCHouse-D](#) console, and select the Tencent Cloud TCHouse-D cluster which requires DLC query acceleration on the **Cluster List** page. Click the cluster name to view the cluster.

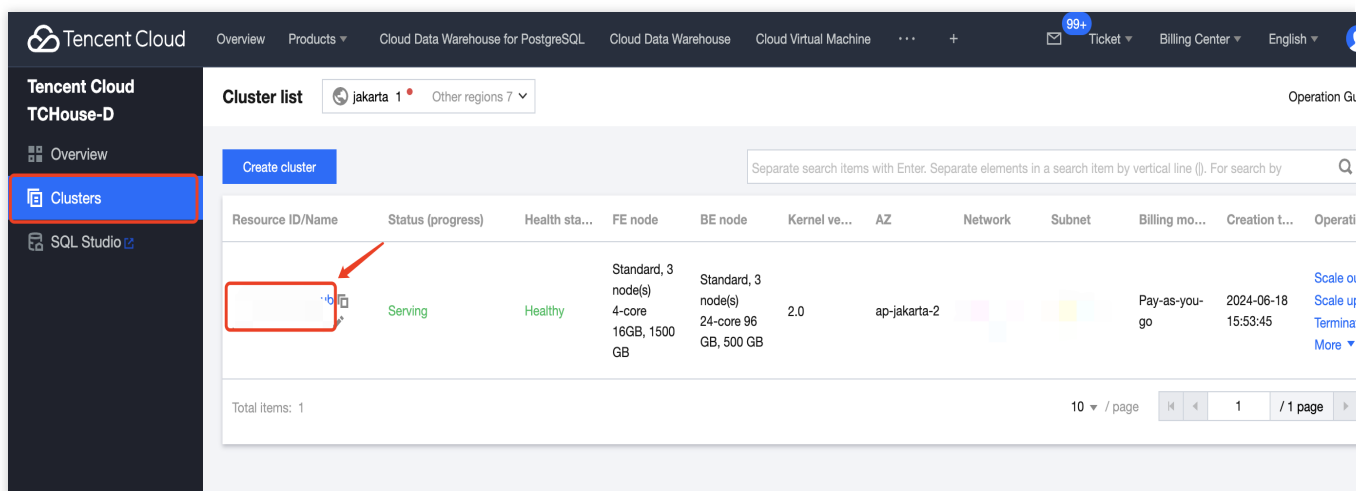

2. In the Lakehouse Integration page, you can see whether Lakehouse Integration is enabled. Click on the switch to enable Lakehouse Integration.

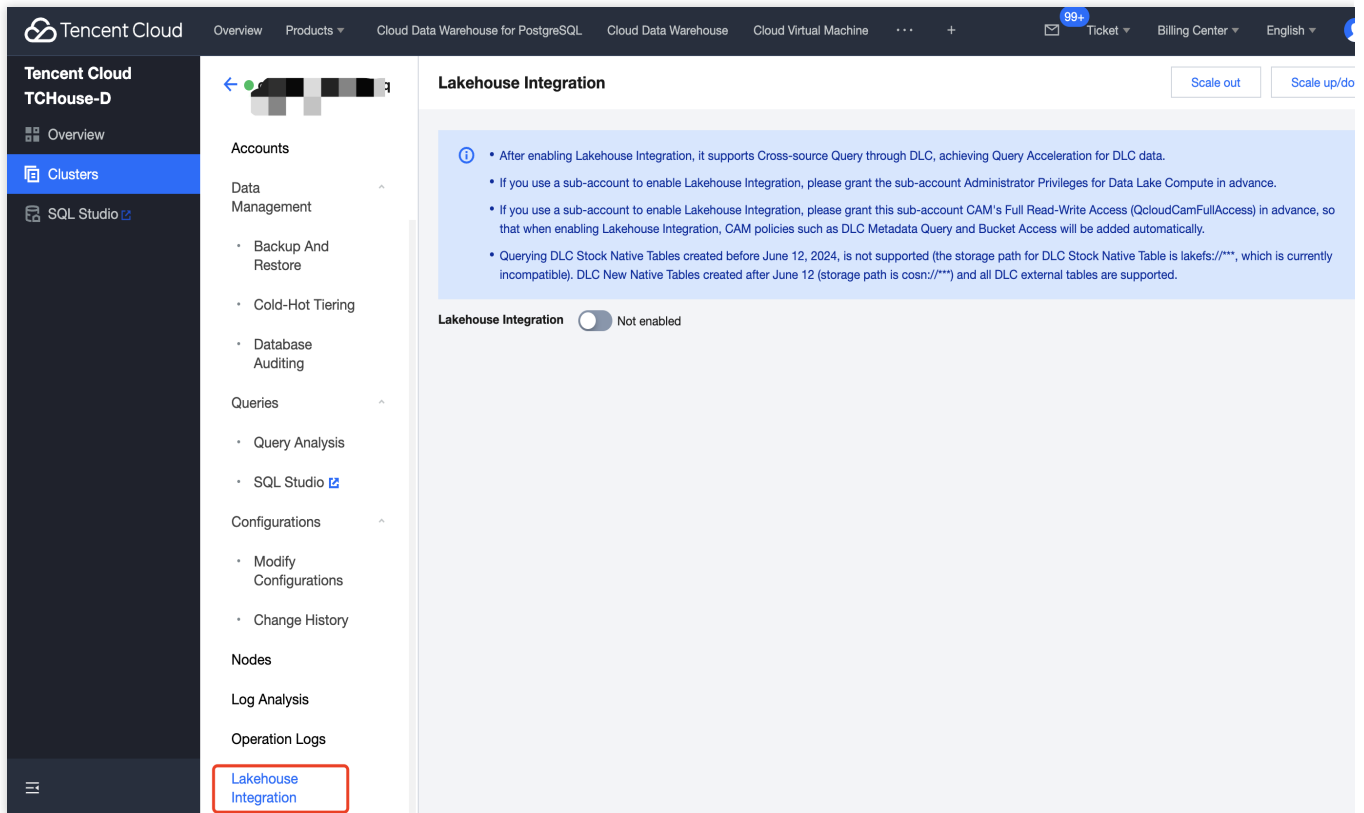

3. To enable Lakehouse Integration, you need to have the administrator permissions on DLC. Please use the root account (or a sub-account with the administrator permissions on DLC) to perform this operation.

Note:

1. You may skip this step if you already have administrator permissions on DLC.
2. If you are using a sub-account without the administrator permissions on DLC, please refer to the document [Sub-Account Permission Management](#) and get granted through an account that has administrator permissions on DLC.

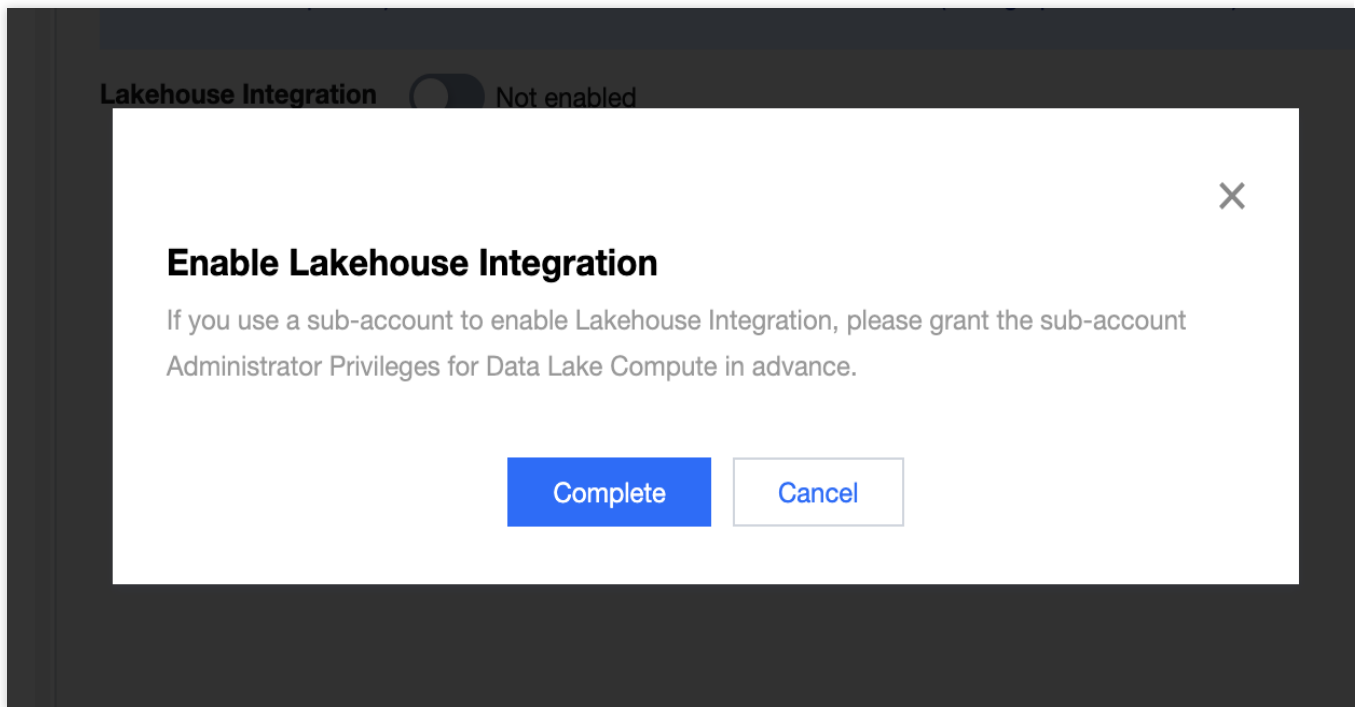

4. Click on the Lakehouse Integration switch and enter the configuration page.

Field	Field Description
Catalog name	Customized as needed. It can contain up to 50 characters consisting of digit, letters, and _, but can not start with a digit. Tencent Cloud TCHouse-D will pull metadata from DLC through Catalog method.
SecretId/SecretKey	It can be the SecretId/SecretKey of the root account or sub-account. Note: If you enter the SecretId/SecretKey of a CAM sub-account, please grant that sub-account with the full read-write permissions (QcloudCamFullAccess) in advance.
Enable Metadata Auto-refresh	No: It supports manual metadata refresh only. Yes: Metadata refresh time can be specified to have metadata periodically pulled from DLC and updated.

Enable Lakehouse Integration



- Before lakehouse integration is enabled, you need to authorize the authentication account access to the DLC storage bucket.
- Ensure that the data storage for DLC is under the COSN path, e.g., cosn://* (lakefs://*** is not supported)**

Catalog name *

test1



Manage DLC metadata through the Catalog. Please customize the Catalog name.

SecretId *

asc



SecretKey *

..



Enable Metadata Auto-Refresh

☐

Yes

Note: Please enter the account's SecretId/SecretKey to obtain DLC Metadata and data Query Permission. If you enter the SecretId/SecretKey of a CAM Sub-account, the relevant CAM policies for DLC (including: DLC Read-Write Strategy, DLC Bucket Access Policy, etc.) will be synchronized for this Sub-account.

Bind and enable policy

Cancel

5. After configuring the above, click the Bind and enable button to complete enabling Lakehouse integration.

Field	Field Description
Edit	Click Edit to modify the Catalog name, SecretId, SecretKey, and Metadata automatic refresh mode.
Manual Update	Click the Manual Update button to manually refresh and pull the metadata from DLC.

Lakehouse Integration [Scale out](#) [Scale up/down](#)

Info

- After enabling Lakehouse Integration, it supports Cross-source Query through DLC, achieving Query Acceleration for DLC data.
- If you use a sub-account to enable Lakehouse Integration, please grant the sub-account Administrator Privileges for Data Lake Compute in advance.
- If you use a sub-account to enable Lakehouse Integration, please grant this sub-account CAM's Full Read-Write Access (QcloudCamFullAccess) in advance, so that when enabling Lakehouse Integration, CAM policies such as DLC Metadata Query and Bucket Access will be added automatically.
- Querying DLC Stock Native Tables created before June 12, 2024, is not supported (the storage path for DLC Stock Native Table is lakefs://***, which is currently incompatible). DLC New Native Tables created after June 12 (storage path is cosn://***) and all DLC external tables are supported.

Lakehouse Integration ☒ Enabled [Edit](#)

Account Status Check Normal status

DLC Catalog Name

Metadata Refresh Interval 60 S

Configure DLC Access Permissions

Go to Account Management to configure data permissions for the TCHouse-D account for DLC.

[Go to Account Management](#)

Use SQL Workspace to link to DLC

Go to SQL Workspace to enable query acceleration for DLC.

[Go to SQL Studio](#)

6. Before querying DLC through Tencent Cloud Data TCHouse-D, go to the Tencent Cloud Data TCHouse-D console and then [Account Management](#) to grant query permissions on the DLC database table.

Log Analysis

Modify permissions

Account *

Host

%

Grant Cluster Management Permissions ⓘ☐ Enable

Permission Configuration *

Permission Type	Scope of application	General permissions	High-risk permissions
▼ Global Permissions	Globally Effective	<input checked="" type="checkbox"/> Query <input checked="" type="checkbox"/> Insert	<input checked="" type="checkbox"/> Alter <input checked="" type="checkbox"/> Delete <input checked="" type="checkbox"/> Create

Data Directory Name

General permissions ⓘ

High-risk permissions ⚠

▼ internal

☒ Query ☒ Insert

☒ Alter ☒ Delete ☒ Create

Database/Table	General permissions ⓘ	High-risk permissions ⚠
▶ <div></div>	<input type="checkbox"/> Query <input type="checkbox"/> Insert	<input type="checkbox"/> Alter <input type="checkbox"/> Delete <input type="checkbox"/> Create
▶ <div></div>	<input type="checkbox"/> Query <input type="checkbox"/> Insert	<input type="checkbox"/> Alter <input type="checkbox"/> Delete <input type="checkbox"/> Create
▶ <div></div>	<input checked="" type="checkbox"/> Query <input type="checkbox"/> Insert	<input type="checkbox"/> Alter <input type="checkbox"/> Delete <input type="checkbox"/> Create
▶ <div></div>	<input checked="" type="checkbox"/> Query <input type="checkbox"/> Insert	<input type="checkbox"/> Alter <input type="checkbox"/> Delete <input type="checkbox"/> Create

Confirm

Cancel

7. After the authorization, go to the **MySQL Client** or click [SQL Workspace](#) to enter the SQL workspace where you can accelerate query DLC through Tencent Cloud TCHouse-D.

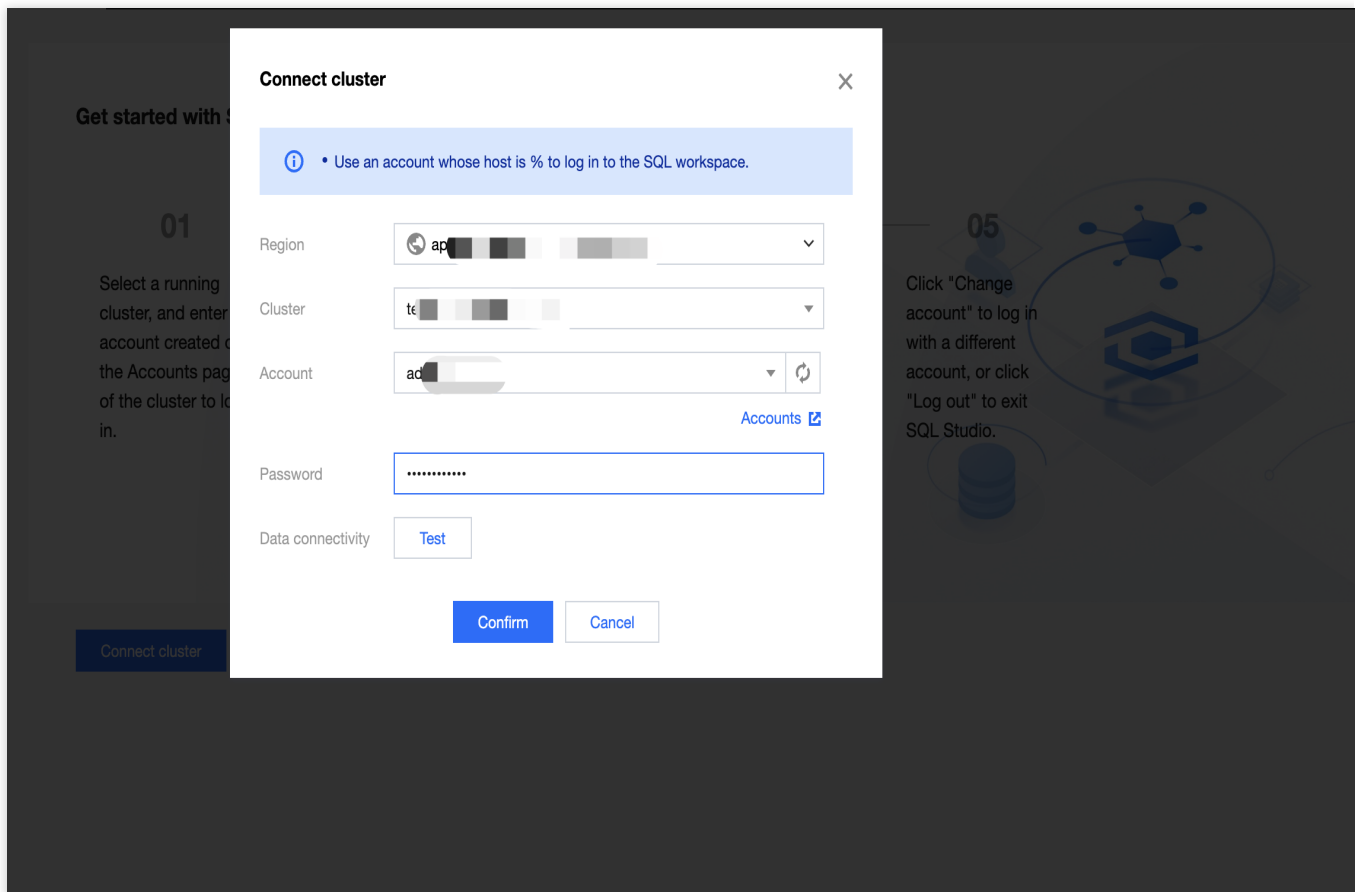

8. In the SQL workspace, you can view the authorized database tables on the left side of the page and conduct queries through the SQL editor as needed.

test1

+

⌂

Data sources ⓘ

+

↻

Welcome

Console information_...

Console mysql

SQL 1

+

Hong Kong (China)

default_cluster

test1

Switch user

Log

Catalog or database name

Q

internal

information_schema(default_...

mysql(default_cluster)

sub_dlc_0701

Unconnected clusters 1

yajiaC20-开日志(cdwdris-c

Table

View

↻

Search

Q

character_sets

collations

column_privileges

column_statistics

columns

engines

events

files

global_variables

key_column_usage

metadata_name_ids

parameters

partitions

processlist

profiling

referential_constraints

routines

Running

Format

Enable query profile

Target node Random

1

2

select * from character_sets limit 10

Execution log

Query result (sequence number: 863)

↻

Separate multiple filter tags with the Enter key.

Q

No.	Start time	Execution d...	Executi... ⌵	Node ⌵	Executing u...	Execute...	Query result	Exo...
863	2024-07-23 11:04:35	51 ms	Successful	10.22.0.7	test1	selec... 📄	Query result	-
862	2024-07-23 11:04:25	15 ms	Successful	10.22.0.29	test1	selec... 📄	Query result	-