

Multiple Network Acceleration

Purchase Guide

Product Documentation



Copyright Notice

©2013–2026 Tencent Cloud. All rights reserved.

Copyright in this document is exclusively owned by Tencent Cloud. You must not reproduce, modify, copy or distribute in any way, in whole or in part, the contents of this document without Tencent Cloud's the prior written consent.

Trademark Notice

 Tencent Cloud

All trademarks associated with Tencent Cloud and its services are owned by the Tencent corporate group, including its parent, subsidiaries and affiliated companies, as the case may be. Trademarks of third parties referred to in this document are owned by their respective proprietors.

Service Statement

This document is intended to provide users with general information about Tencent Cloud's products and services only and does not form part of Tencent Cloud's terms and conditions. Tencent Cloud's products or services are subject to change. Specific products and services and the standards applicable to them are exclusively provided for in Tencent Cloud's applicable terms and conditions.

Contents

Purchase Guide

Business Model

Free Device Licenses and Acceleration Traffic During the Trial Period

Billing Overview

Automatic Renewal Service Policy

Cost Consumption Process

Purchase Guide

Business Model

Last updated: 2026-05-21 10:48:58

Multiple Network Acceleration (MNA) are categorized into two types based on the service environment: Cloud Gateway and Customer-Owned Gateway.

- The fees charged for Public cloud gateway service include **Device license fee** and **Acceleration traffic fee**.
- The fees charged for service targeting customer private gateway include **Device license fee** and **Acceleration traffic fee**.

The specific fees are as shown in the table below.

Access Mode	Billable Item	Billing Category	Billing Mode
Cloud Gateway	Device license fee	Permanent License	Prepaid
		Monthly Active Billing	Postpaid
	Accelerated traffic fee	Monthly Traffic Package	Prepaid
		Pay-as-you-go	Postpaid
Customer-Owned Gateway	Device license fee	Permanent License	Prepaid
		Monthly Active Billing	Postpaid
	Gateway license fee	Monthly gateway License	Postpaid

Access Method

Cloud Gateway

Cloud Gateway refers to the aggregation gateway deployed in Tencent Cloud IDC (distributed deployment in 30+ locations worldwide). Terminals/clients are automatically connected to nearby gateways. The default gateway for Multiple Network Acceleration service is Cloud Gateway, which is maintained by Tencent Cloud. In this environment, there are two payment items: device authorization fee and acceleration traffic fee.

- Device authorization fees can be divided into **permanent authorization License** and **monthly active billing**. In terms of billing mode, the former is prepaid, while the latter is pay-as-you-go.
 - **Permanent authorization License** means the customer pays a one-time payment before using it with no need to pay subsequently.

- **Monthly active billing** refers to payment at the end of month based on whether the device is active. This billing item requires special approval and is selectable after adding to allowlist.
- Accelerated traffic fees can be divided into **monthly traffic** and **pay-as-you-go billing**. In terms of billing mode, the former is prepaid, while the latter is postpaid.
 - **Monthly traffic** means the customer purchases a traffic package before using it, and the traffic generated during the acceleration process will be deducted from the package.
 - **Pay-as-You-Go** refers to payment at the end of month based on actual accelerated stream.

Customer Private Gateway

Customer private gateway refers to the aggregation gateway deployed in customer server room or third-party cloud, with basic resources provided by the customer but under Unified Management by Multiple Network Acceleration service. In this environment, two payment items are generated: device authorization fee and gateway authorization fee.

- Device authorization fees can be divided into **permanent authorization License** and **monthly active billing**. In terms of billing mode, the former is prepaid, while the latter is pay-as-you-go.
 - **Permanent authorization License** means the customer pays a one-time payment before using it with no need to pay subsequently.
 - **Monthly active billing** refers to payment at the end of month based on whether the device is active. This billing item requires special approval and is selectable after adding to allowlist.
- Gateway authorization fee refers to monthly gateway License, charged monthly and belongs to postpayment.

Free Device Licenses and Acceleration Traffic During the Trial Period

Last updated: 2026-05-21 11:14:25

Feature Overview

Multiple Network Acceleration (Tencent Cloud Jutong) provides a standardized free trial experience for customers. After applying for the "Beta", customers receive a **2-month free trial period**. During this period, they can unlock features such as usage monitoring and group management. For the trial phase, **device licenses and acceleration traffic** are provided free of charge for a limited time. Other features (such as private gateways, vendor devices, traffic packages, and IP address interconnection, and so on) **are charged at the standard rates**.

By default, each account can apply for **5 free test keys** (regardless of whether the access method is per-device-per-secret or based on the number of devices connected per application).

How to Enable the Trial Experience

Go to the [Multiple Network Acceleration \(Tencent Cloud Jutong\) console](#). A "Beta" entry is added in the upper-right corner of the console.

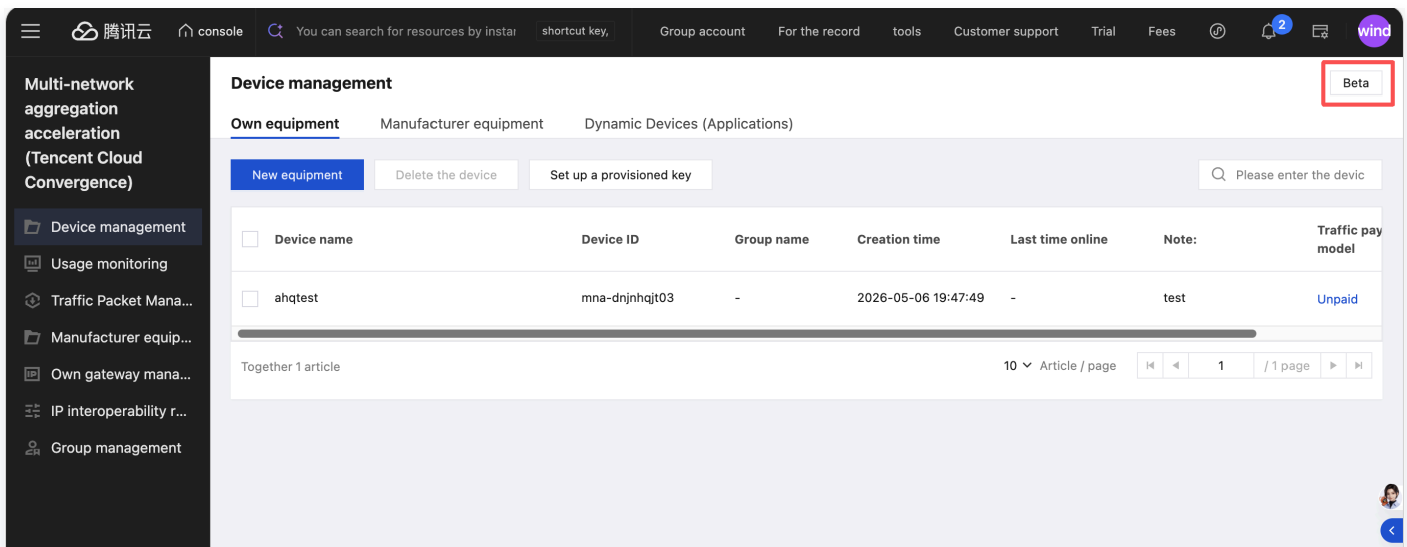

1. Click Beta. A prompt window appears as follows:

Window content description: After claiming the Trial Edition, you will receive a two-month free trial period. During this period, you can unlock features such as usage monitoring and group management for the Multiple Network Acceleration SDK. For the trial phase, device licenses and acceleration traffic are provided free of charge for a limited time. Other features (such as private gateways, vendor devices, traffic packages, IP address interconnection, and so on) are charged at the standard rates.

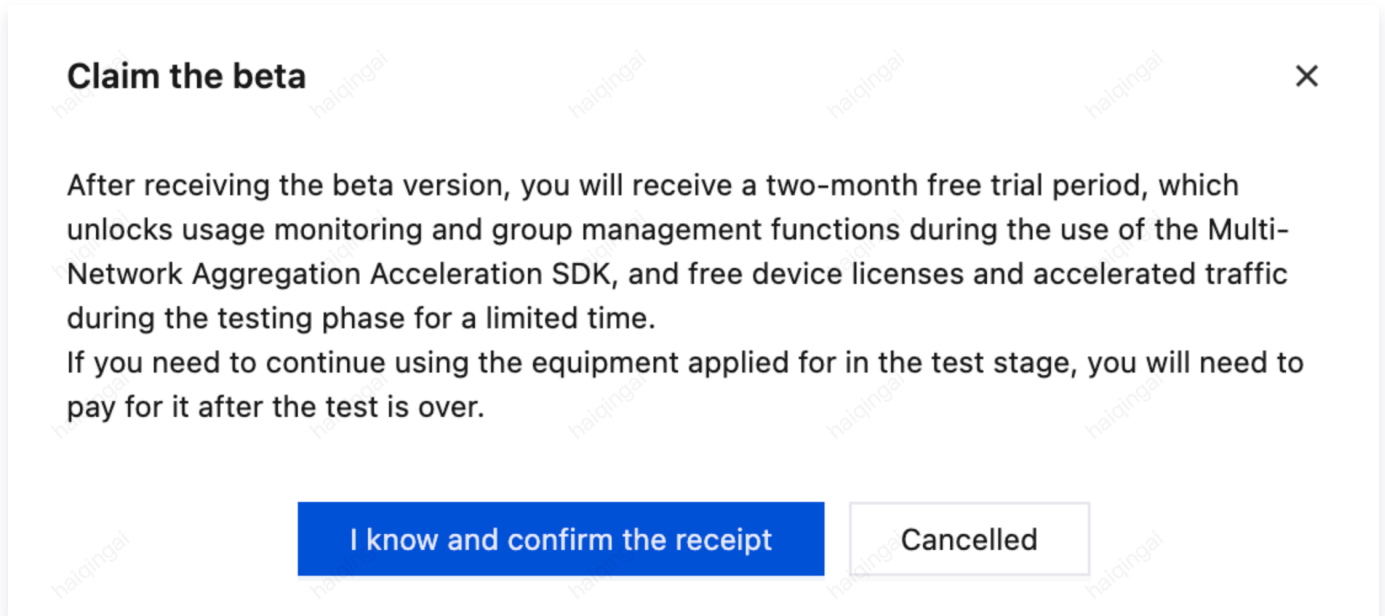

2. After reading and confirming, click **"I know and confirm the receipt"** to complete the claim. The free trial period is 2 months, starting from the user's confirmation of the claim.
3. After the claim is successful, the "Trial Edition" entry in the upper-right corner of the console is changed to "Testing phase".

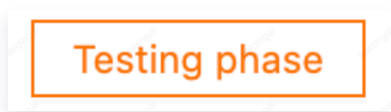

Device Application

During the trial phase, you can apply for both private devices and dynamic devices.

Dedicated Devices (One Device, One Secret)

- Key Application: Currently, only the keys provided by the platform are supported, and the access environment must be the public cloud gateway. If you select other configurations, an error message will appear in a pop-up window upon saving, and the correct selection content will be prompted.
- Secondary encryption is not supported: The secondary encryption feature is not supported during the trial phase.
- Key quantity limit: By default, an account can apply for 5 keys. The trial period for the account is 2 months, starting from the confirmation of claiming the Trial Edition.
- Application frequency limit: The application fails when the number of applications exceeds the free quota (5 times). A pop-up window displays the message "You have reached the maximum number of applications (5 times). For more, please contact paid support."

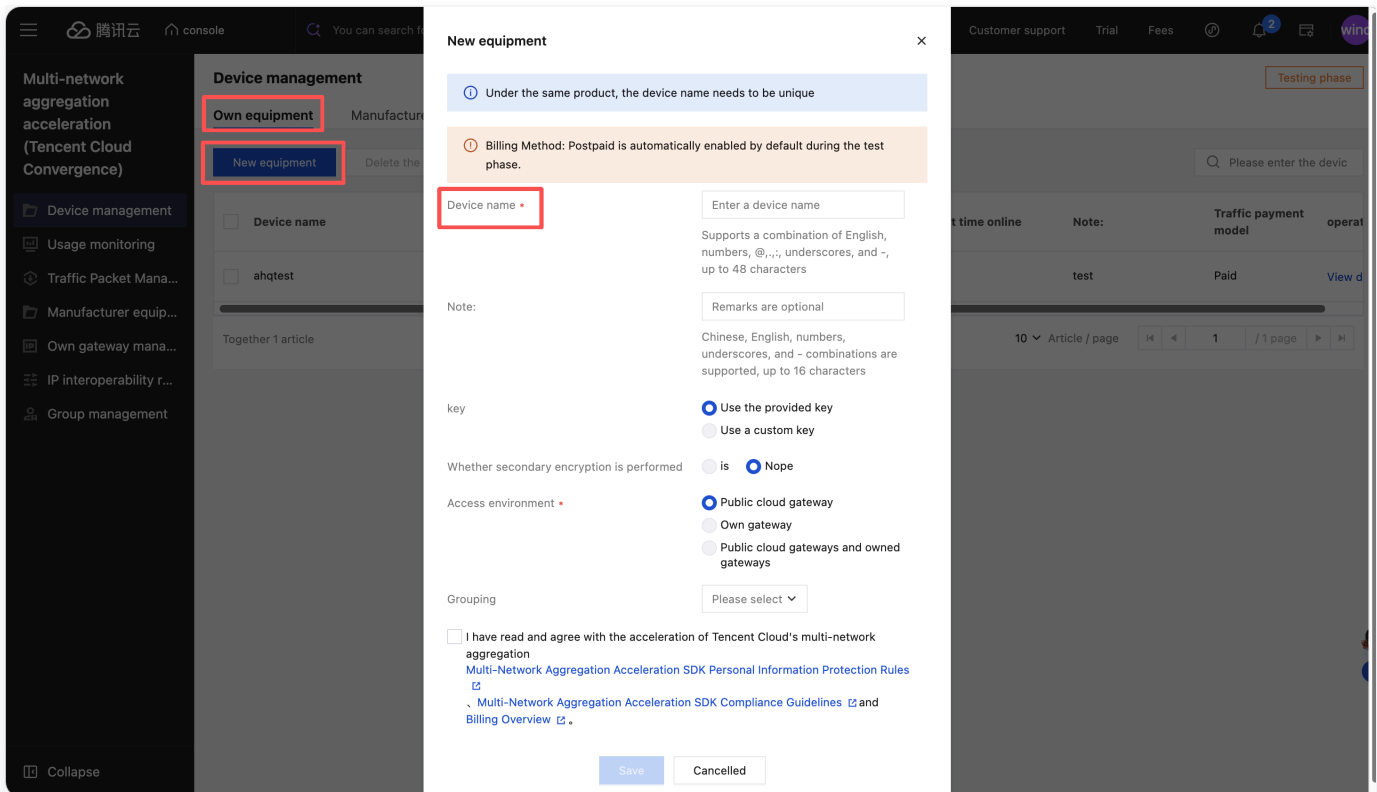

Dynamic Devices (Access by Application)

- Key Application: You can only select and use the keys provided by the platform, and the access environment must be the public cloud gateway. If you select other configurations, an error message will appear in a pop-up window upon saving, and the correct selection content will be prompted.
- Secondary encryption is not supported: The secondary encryption feature is not supported during the trial phase.
- Key quantity limit: By default, an account can apply for 5 keys (regardless of whether it's one key per device or based on the number of devices connected per application). The trial period for the account is 2 months, starting from the confirmation of claiming the Trial Edition.
- Application frequency limit: The application fails when the number of applications exceeds the free quota (5 times). A pop-up window displays the message "You have reached the maximum number of applications (5 times). For more, please contact paid support."

Create a new app ×

i Under the same product, the application name needs to be unique

! Experience stage: The key is provided by the provided key, and the access environment is a public cloud gateway

App name *
Supports a combination of English, numbers, @,.,:, underscores, and -, up to 48 characters

Note:
Chinese, English, numbers, underscores, and - combinations are supported, up to 16 characters

key Use the provided key Use a custom key

Access environment * Public cloud gateway Own gateway
 Public cloud gateways and owned gateways

Checking the Testing Phase Status

After the trial phase is entered, the text "Testing Phase" is displayed in the upper-right corner of the console. When "Testing Phase" is clicked, a status information window opens, which displays the following content:

- Trial Phase Start Time
- Trial Phase Expiration Time
- Days Remaining
- Remaining Key Application Quota

Click "End the test" within the pop-up window to end the trial phase early.

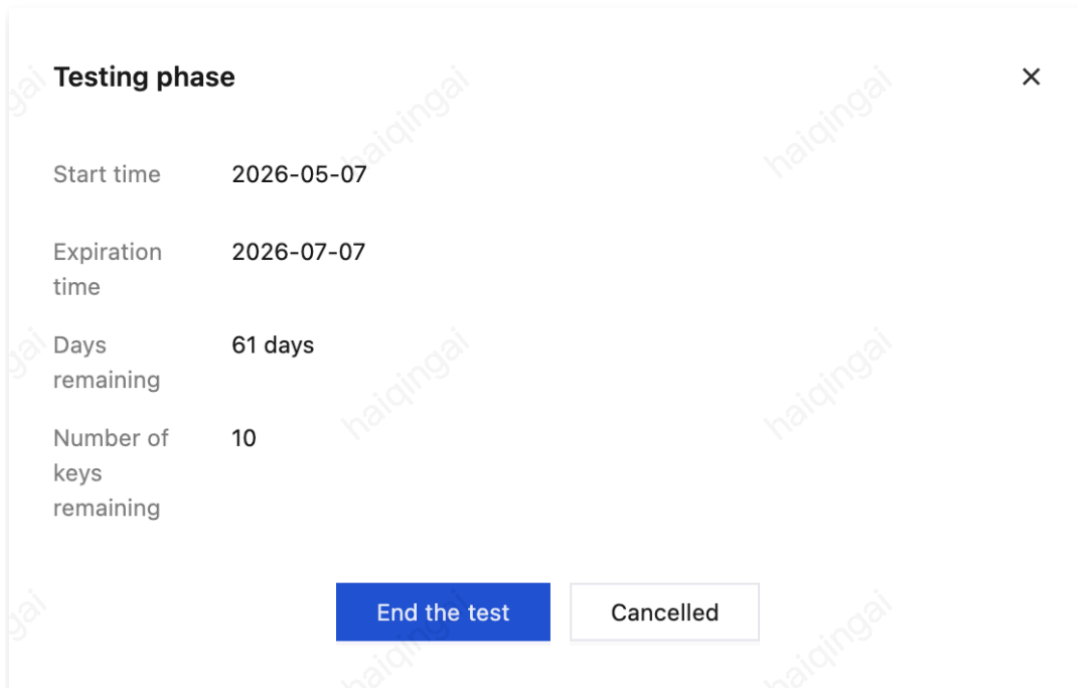

New User Creation Information Reminder: When a user creates a new test device, the device name, device ID, and creation time are automatically recorded.

Ending the Testing Phase

When the trial phase expires or the user actively ends the trial, the system displays a pop-up window. The user can then choose from the following actions:

- Continue using: Switch to formal paid service. Device licenses and traffic begin to be billed normally. For billing details, see [Billing Overview](#).
- Stop using: The keys used during the trial phase will be revoked, and devices can no longer use the Multiple Network Acceleration service. **[Important Reminder] This operation is irreversible. After you stop using the service, the trial keys will be revoked, and devices will no longer be able to use the Multiple Network Acceleration service. Proceed with caution.**

For more billing information, see [Billing Overview](#).

Billing Overview

Last updated: 2026-05-21 10:57:52

Billing Breakdown

Multiple Network Acceleration product billing includes device SDK license fees and traffic charges that may incur when using the service.

- SDK authorization fee: Purchase a device License to use the service. Monthly payment is supported.
- Traffic charges: After activating the service, starting the device with Enhanced Acceleration Service will generate traffic. Currently supported purchase modes are pay-as-you-go by monthly usage and prepayment for monthly traffic packages.

The billing items can be purchased based on your business needs.

Billing Description

SDK Authorization Fee

Billing Logic

Device access service requires purchasing the Device Access SDK authorization fee, which is the device License fee.

This billing item supports the pay-as-you-go mode, with monthly billing and authorization validity period calculated by calendar month.

Creating a device will not generate a device License fee. The device License fee is triggered when the device is activated and settled along with other fees at the beginning of the next month.

Billing is automatically activated after the device generates traffic.

List Price

For the specific price, please refer to the quotation from the business manager.

Billing Example

The customer created 3 devices on May 20, 2023, and activated 2 device licenses on May 24, 2023.

At 23:59 on May 31, 2023, the 2 monthly authorizations will expire. The monthly authorization fee will be deducted in the June 2023 settlement.

If continuing to use the device with monthly authorization License next month, the monthly License authorization fee for June will be settled and deducted in July 2023.

Devices that are successfully created but not activated and do not generate traffic will not incur License authorization fees.

Traffic Fee

Billing Logic

Traffic refers to the sum of uplink and downstream traffic generated when devices use the Multiple Network Acceleration service, accurate to two decimal places. The settlement amount is calculated according to the traffic usage in the current month, and traffic statistics are irrelevant to device quantity. Pay-as-you-go billing takes effect by natural month and settles the traffic fees generated in the previous month at the beginning of each month.

Billing is automatically activated after traffic is generated.

List Price

For the specific price, please refer to the quotation from the business manager.

Billing Example

Postpaid pay-as-you-go billing: If a customer uses 5.12G of traffic in May, the cost to be settled for the current month = 5.12G * traffic unit price.

Prepaid Traffic Package billing: A customer purchases a 20GB monthly traffic package and uses 15GB of traffic in the current cycle. The traffic generated in the current cycle can be deducted using the traffic package, and no other traffic fees will be incurred.

Automatic Renewal Service Policy

Last updated: 2026-05-21 11:00:20

This rule description explains the auto-renewal rules for Prepaid Traffic Resource Packs, as well as how to set up and cancel automatic renewal.

Auto-Renewal

The automatic renewal in this guide refers to a convenient renewal service provided to customers who purchase multi-network aggregation acceleration (Tencent Cloud Jutong) traffic packages. If the user authorizes the automatic renewal service when purchasing a traffic package, the system will automatically purchase a traffic package according to the configuration and **deduct fees from the user-specified payment account** when the traffic package expires or resources are exhausted.

Users can cancel automatic renewal at any time.

Set Auto-Renewal Label

1.Set Auto-Renewal on the Purchase Page

When purchasing a traffic package on the purchase page, if the "Automatic Renewal" option is checked, it means the user authorizes the multi-network aggregation acceleration (Tencent Cloud Jutong) business to automatically place an order for a new traffic package according to the current configuration when the purchased traffic package expires or resources are exhausted.

The newly purchased traffic package will maintain the current gear selection and application configuration at the time of purchase.

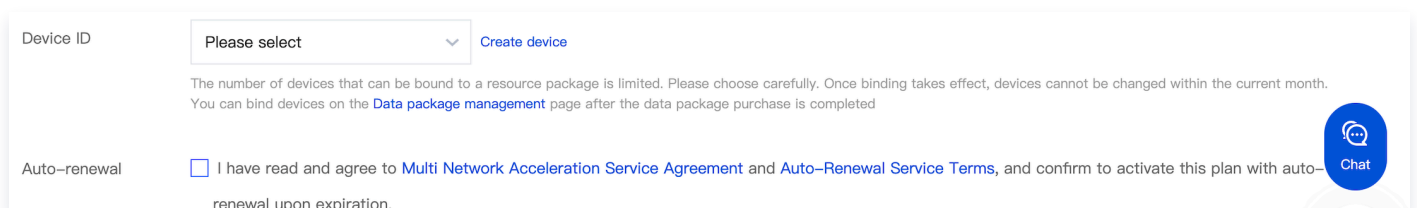

The screenshot shows a form for setting up automatic renewal. It includes a 'Device ID' dropdown menu with the text 'Please select' and a 'Create device' link. Below this is a warning message: 'The number of devices that can be bound to a resource package is limited. Please choose carefully. Once binding takes effect, devices cannot be changed within the current month. You can bind devices on the [Data package management](#) page after the data package purchase is completed'. The 'Auto-renewal' section has a checkbox that is currently unchecked, with the text: 'I have read and agree to [Multi Network Acceleration Service Agreement](#) and [Auto-Renewal Service Terms](#), and confirm to activate this plan with auto-renewal upon expiration.' A blue 'Chat' button is visible in the bottom right corner.

2.Set Auto-Renewal Via API

If the auto-renewal label is configured when purchasing a traffic package via the API, it means the user authorizes the multi-network aggregation acceleration (Tencent Cloud Jutong) business to automatically place an order for a new traffic package according to the current configuration when the purchased traffic package expires or resources are exhausted.

Place an order for a traffic resource package via the API and set the auto-renewal label. For details, see the API documentation guide.

- [Purchase a data transfer plan](#) and bind it.
- [Modify the auto-renewal flag of the data transfer plan](#).

Auto-Renewal Failed

When auto-renewal is enabled for a traffic package, the fund will be deducted from the customer-authorized account. If the account balance is insufficient when deducting, the traffic package **auto-renewal failed**. If the bound device continues to generate traffic, a postpaid bill will be generated.

Canceling Automatic Renewal

Customers can cancel the auto-renewal label of traffic packages at any time when using the multi-network aggregation acceleration (Tencent Cloud JT) service, and the current service remains unaffected.

After canceling the auto-renewal label of the traffic package, **it will not auto-renew** if the current traffic package expires or resources are exhausted.

1.Cancel Automatic Renewal Tag in the Console

Enter the multi-network aggregation acceleration (Tencent Cloud JT) console, select the resource package management page. Select the data transfer plan for which you need to cancel automatic renewal, and enter the management page.

Click the auto-renewal switch. If the switch is off, renewal is canceled. If needed, you can reopen it at any time.

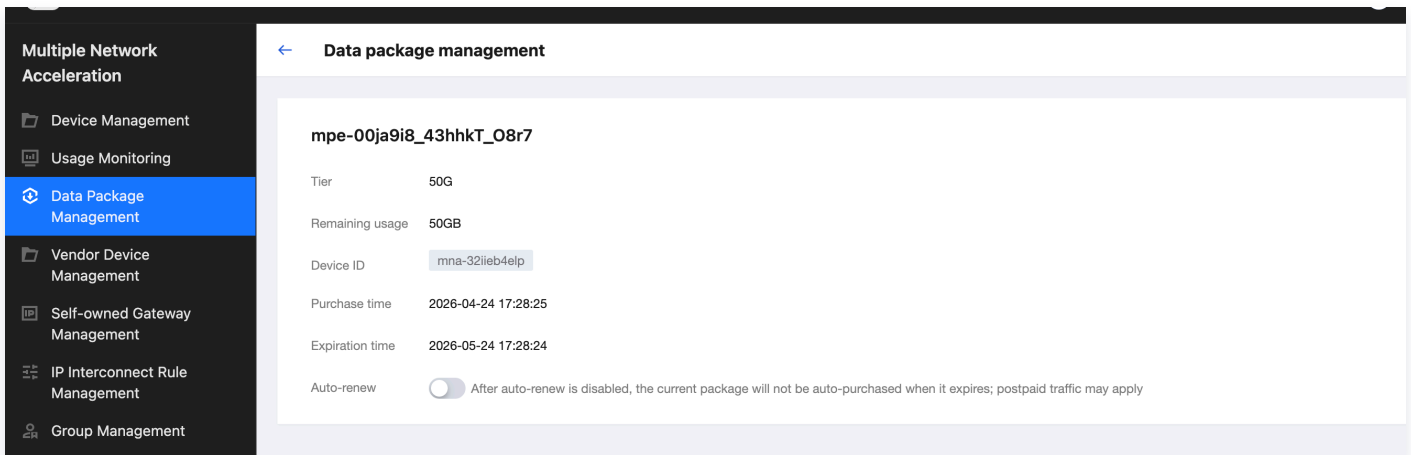

2.Cancel Automatic Renewal Tag Via API

To modify the auto-renewal label via the API, refer to the API documentation guide [Modify the auto-renewal flag of the traffic package](#).

Auto-Renewal Notification

When a traffic package with auto-renewal is about to expire or run out, the system will automatically send a notification. As needed by customers, they can change configuration or cancel renewal.

After canceling auto-renewal, if you continue to use the traffic package after it expires or resources are exhausted, postpaid traffic bills will be generated.

Cost Consumption Process

Last updated: 2026-05-21 11:32:04

Overall Logic for Accessing a Public Cloud Gateway

1. The device license fee and the acceleration traffic fee are decoupled.
2. **Device Service Handling Rules When No Data Transfer Plan Is Available.**

After a data transfer plan expires or its quota is exhausted, the device is assigned two binary service handling attributes, as detailed below:

- **Pay-as-you-go (Postpaid) Mode:** After the data transfer plan expires or is exhausted, the device can continue to use the traffic service. The traffic usage is billed according to the pay-as-you-go standard, and the fees are settled uniformly at the end of each month.
- **Acceleration Service Cutoff Mode:** After the data transfer plan expires or its quota is exhausted, the system directly blocks the device's traffic acceleration service and no longer provides the related network acceleration capability.

3. **Data Transfer Plan Auto-Renewal Attribute.**

The data transfer plan supports the auto-renewal feature.

- For a data transfer plan with auto-renewal enabled, the renewal operation is automatically completed and the service continues after the plan expires or its quota is exhausted.
- For a data transfer plan without auto-renewal enabled, the device service handling rules for when no data transfer plan is available, as described above, are applied after the plan expires or its quota is exhausted.

4. **Data Transfer Plan Device Binding Attribute.**

The data transfer plan supports the feature of multi-device binding. A single data transfer plan can be bound to multiple devices simultaneously. The validity period and available quota of the data transfer plan used by each bound device are determined based on the initial configuration of that specific plan.

5. **Usage Priority Rules Under Multi-Data-Transfer-Plan Ownership.**

A single device can belong to multiple data transfer plans simultaneously. During actual traffic usage, the system by default prioritizes invoking and consuming the resources of the earliest created data transfer plan. After that plan expires or is exhausted, the system then enables the subsequently created data transfer plans in sequence.

